

CEVB Pressure-Relief Type Oil Electric Lubricator

PLC

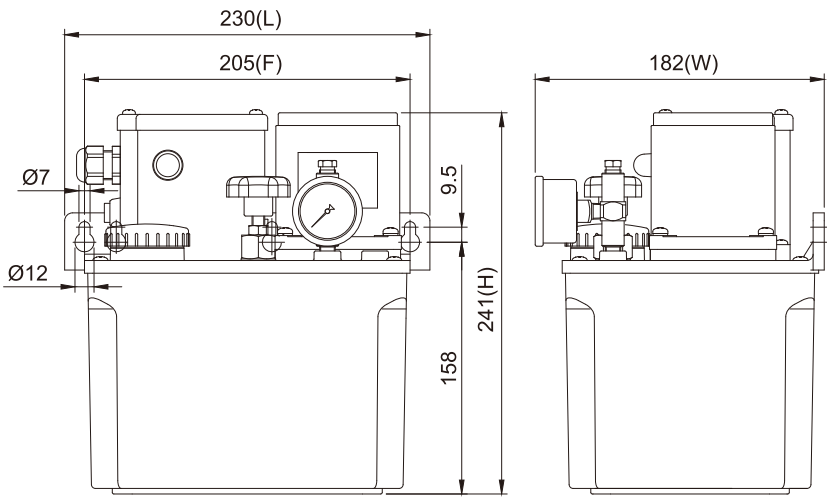

CEVB Pressure-Relief Type Oil Electric Lubricator



Dimensional Drawing of CEVB-03-C-25-3-F-L

◆Features

1. The operation and interval time of CEVB are controlled by PLC.
2. CEVB has to work with volume distributors to deliver the metered quantity of oil to the lubrication points.
3. CEVB has a pressure gauge that enables the user to check the operating pressure easily.
4. CEVB has an 8kgf/cm² NC contact socket pressure switch that detects the operating pressure automatically and sends a signal when the pressure is below the preset value.
5. CEVB has a NC contact float switch that detects the oil level automatically and sends signals when the oil level is low.
6. CEVB has a pressure-regulating valve that enables the user to adjust the operating pressure.
7. The gear pump of CEVB is made of special aluminum alloy and assembled with the induction motor to provide stable output pressure, low operating noise, and long service life.
8. CEVB can be added with the following parts on request.
 - A feed-oil button can be used for manual oil feeding.
 - An indicator light that shows when CEVB discharges oil.

◆Dimensional Data

Motor Power	Tank Capacity	Tank Material	Length (mm)	Width (mm)	Height (mm)	Fixed Hole Distance (mm)	N.W. (kg)
25W	3L	Resin	230	182	241	205	4.89
	4L	Resin	288	162	252	250	5.37
	4L	Aluminum	297	170	250	95x280	6.25
	8L	Iron	355	201	273	95x338	9.52
60W	4L	Aluminum	297	175	310	95x280	7.87
	8L	Iron	355	201	332	95x338	11.35

CEVB Pressure-Relief Type Oil Electric Lubricator

PLC

CEVB Pressure-Relief Type Oil Electric Lubricator

Technical Data

Motor Power	25W			60W		
Voltage	1Ø110V	1Ø220V	Three Phase	1Ø110V	1Ø220V	Three Phase
Ampere	0.6A	0.3A	0.3A	1.2A	0.6A	0.6A
Max. Discharge Volume	250cc/min			500cc/min		
Max. Operating Pressure	20kgf/cm²			30kgf/cm²		
Hertz	50/60Hz Compatible					
Discharge Bore	Ø4, Ø6					
Float Switch	NC Contact (NO Contact on request)					
Pressure Switch	NC Contact (NO Contact on request)					
Suitable Viscosity	Oil, 32-68 cSt@40°C					

Order Code

CEVB	03	C	25	3	※
	Tank Capacity (Material)	Voltage		Discharge Bore	Special Request
	03 3L (Resin)	A 1Ø110V		0 Ø4	F Add a Feed-Oil Button
	04 4L (Resin)	C 1Ø220V		1 Ø6	L Add a Indicator Light
	05 4L (Alum.)	D 3Ø220/380V		2 Ø4 W/Pressure Gauge	PO NO Contact Pressure Switch
	08 8L (Iron)	E 3Ø220/440V		3 Ø6 W/Pressure Gauge	SO NO Contact Float Switch
	20 20L (Iron)	F 3Ø208/415V			
		G 3Ø230/460V			
		H 3Ø240/480V			
		M 3Ø220V			
		N 3Ø380V			
		X Special Voltage			
			Motor Power		
			25 25W		
			60 60W (Available for 4L metal tank and above only)		
			90 90W (Available for 4L metal tank and above only)		

※ A standard dual-voltage motor is connected for low voltage. Please specify if you need it to be connected for high voltage when placing an order.

Wiring Diagram

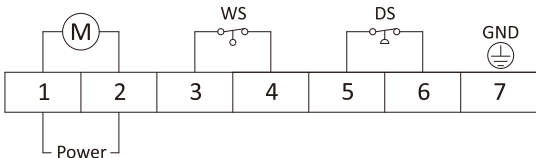
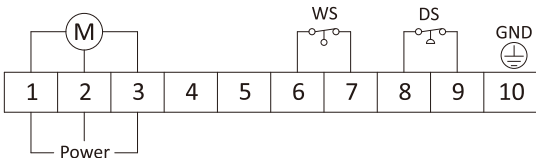
Single-Phase Power	Three-Phase Power
	
M = Motor, GNC = Ground, WS = Float Switch, DS = Pressure Switch	

※ For the CEVB with a feed-oil button and an indicator light, please follow the particular wiring diagram on the CEVB.
 ※ The motor shaft is marked with a red dot. When wiring the three-phase-voltage CEVB, please note that the motor should rotate anticlockwise. If the motor rotates clockwise, please switch the position of any two of the power wires and rewire them.

Related Products

								
P. 89	P. 93	P. 111	P. 113	P. 122	P. 126	P. 125	P. 129	P. 127