

# SOE

型 OPTICAL EDGE FINDER (TOUCH POINT SENSOR)

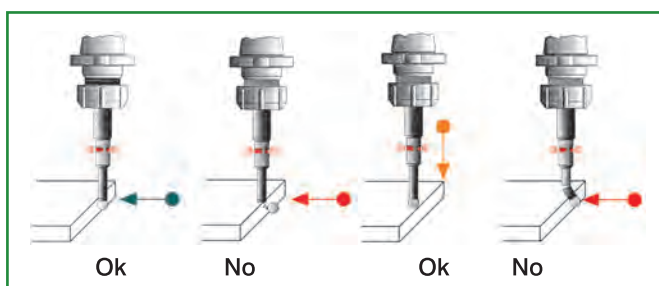

### ● 產品資訊：

1. 不需迴轉測量。
2. 精確度0.005m/m。
3. 附1枚UM5#, 12V鹼性乾電池。

### PRODUCT INFORMATION

- Not necessary to rotate while measuring
- Quickly locate work edges
- Save time to find position, for milling machine, jig borers, and other machine tools
- Accuracy : 0.005mm (Is a High Sensible Position Measuring)
- Battery type : UM5#, 12V x 1 pcs

### FEATURES

- Uses dry batteries to light the red lamp.
- The scope of application includes edge surface, inside and outside diameters and high efficiency.
- There is a safety spring puller which puts the ball precisely back to the positing when ball breaks away from ball seat.

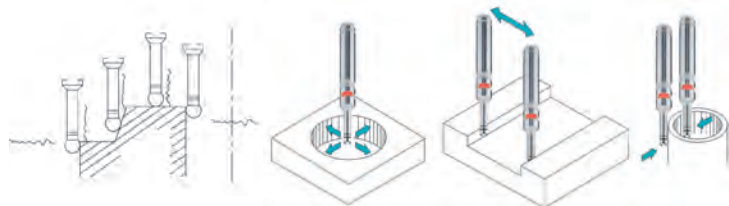
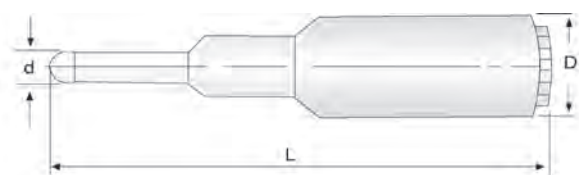

**⚠ 請注意 / 光電式尋邊器不適合迴轉使用**  
 Notice to use of optical edge finder, that is not suitably used for rotary.

單位/Unit:mm

ORDER NO.	TYPE	柄徑.D	長度.L	測頭.d	G.W. WEIGHT kgs	包裝尺寸 L x W x H
08420120	SOE-20S	Ø20	120	Ø10	0.3	200 x 72 x 45
08420020	SOE-20L	Ø20	158	Ø10	0.36	200 x 72 x 45
08420021	SOE-20LB	Ø20	158	Ø10	0.36	200 x 72 x 45
08420032	SOE-32L	Ø32	158	Ø10	0.64	200 x 72 x 45
08420033	SOE-32LB	Ø32	158	Ø10	0.64	200 x 72 x 45

