

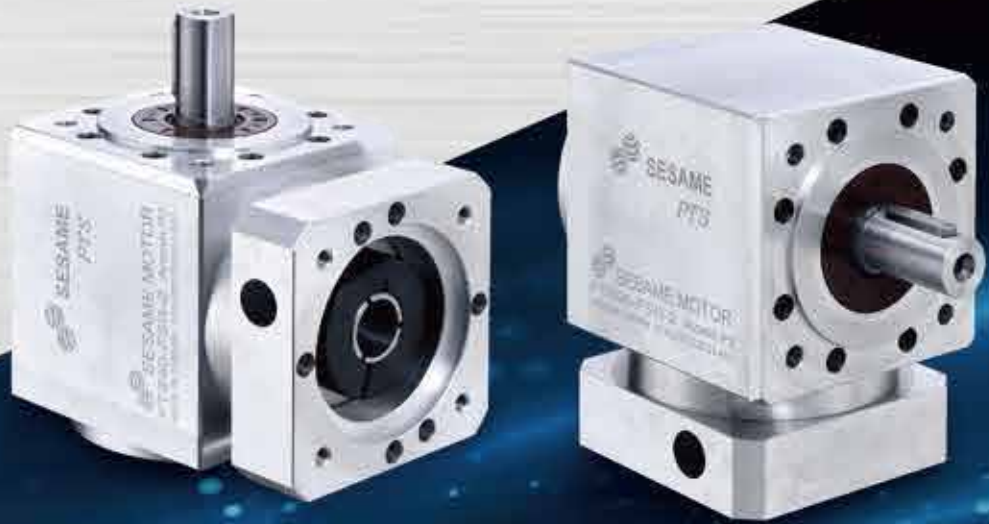

Spiral Bevel Gearbox

螺旋傘齒輪減速機

PT series



PT SERIES



PT-FS Single Stage Dims. 單段外型尺寸圖

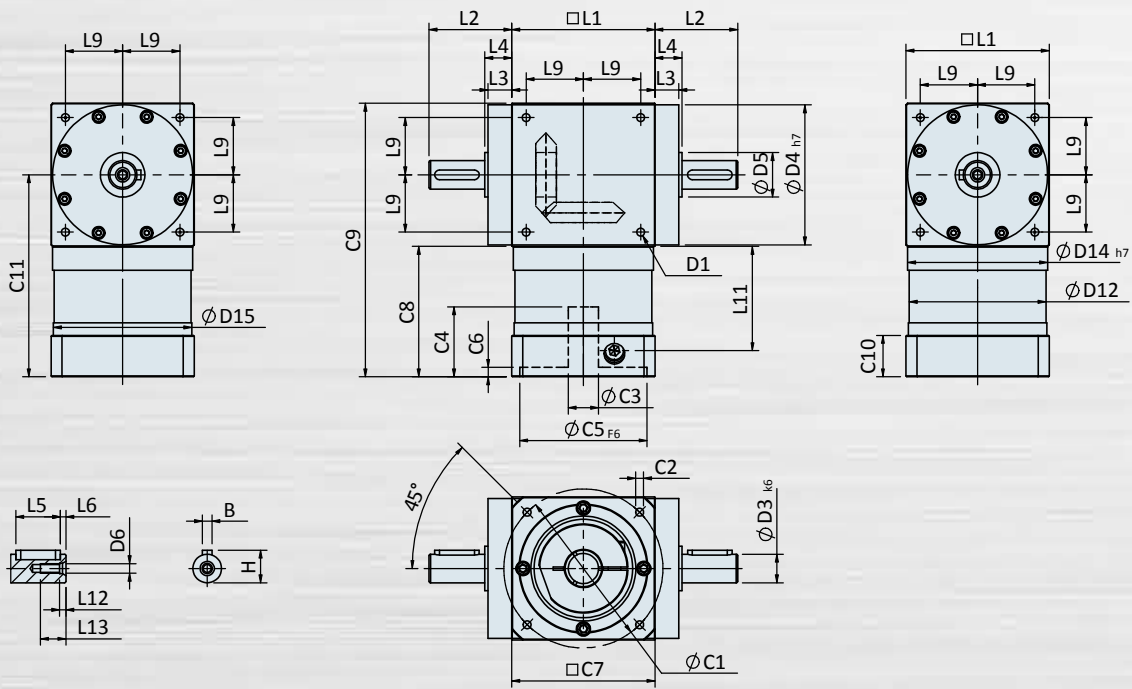

Specifications 規格

Unit: mm

| Dims. 尺寸 | PT60-FS | PT75-FS | PT90-FS | PT110-FS | PT140-FS | PT170-FS | PT210-FS |
|--------------------|-------------|---------|------------|-------------|-------------|--------------|----------|
| D1 | 24-M4x0.7P | - | 24-M6x1.0P | 24-M8x1.25P | 24-M10x1.5P | 24-M12x1.75P | - |
| D2 | - | - | - | - | - | - | - |
| D3k6 | 13 | - | 18 | 22 | 32 | 40 | - |
| D4h7 | 60 | - | 88 | 108 | 135 | 165 | - |
| D5 | 21 | - | 28 | 33 | 47 | 55 | - |
| D6 | M4x0.7P | - | M6x1.0P | M8x1.25P | M12x1.75P | M16x2.0P | - |
| D7 | - | - | - | - | - | - | - |
| D12 | 60 | - | 86 | 106 | 104 | 128 | - |
| D14h7 | 60.2 | - | 88 | 108 | 135 | 165 | - |
| D15 | 41.8 | - | 87 | 107 | 103 | 127 | - |
| L1 | 60.8 | - | 90 | 110 | 140 | 170 | - |
| L2 | 31.5 | - | 52 | 57 | 67 | 77 | - |
| L3 | 10 | - | 15 | 15 | 15 | 15 | - |
| L4 | 12 | - | 17 | 17 | 17 | 17 | - |
| L5 | 16 | - | 28 | 32 | 45 | 50 | - |
| L6 | 2 | - | 3.5 | 4 | 2.5 | 5 | - |
| L7 | - | - | - | - | - | - | - |
| L9 | 24.75 | - | 36 | 44 | 55 | 67 | - |
| L10 | - | - | - | - | - | - | - |
| L11 | 38.2 | - | 65.5 | 77 | 86.4 | 94.1 | - |
| L12 | 4 | - | 4 | 4.5 | 6 | 6 | - |
| L13 | 12 | - | 16 | 20.5 | 30 | 36 | - |
| C1 ¹ | 46 | - | 100 | 100 | 130 | 165 | - |
| C2 ¹ | M4x0.7P | - | M6x1.0P | M6x1.0P | M8x1.25P | M10x1.5P | - |
| C3 ¹ | ≤11/≤14/≤19 | - | ≤19/≤24 | ≤24 | ≤32 | ≤38 | - |
| C4 ¹ | 33 | - | 44 | 47 | 55.1 | 67 | - |
| C5 ¹ | 30 | - | 80 | 80 | 110 | 130 | - |
| C6 ¹ F6 | 4 | - | 6 | 5 | 5 | 6 | - |
| C7 ¹ | 42.6 | - | 90 | 90 | 115 | 140 | - |
| C8 ¹ | 47.2 | - | 82 | 93 | 106 | 118 | - |
| C9 ¹ | 108 | - | 172 | 203 | 246 | 288 | - |
| C10 ¹ | 18.5 | - | 26 | 23 | 27 | 35 | - |
| C11 ¹ | 77.6 | - | 127 | 148 | 176 | 203 | - |
| B | 5 | - | 6 | 6 | 10 | 12 | - |
| H | 15 | - | 20.5 | 24.5 | 35 | 43 | - |

*1. C1~C11 are motor specific dimensions (metric std shown), size may vary according to motor flange. C1~C11是公製標準馬達連接板尺寸，請依所選用的馬達決定。
 ★ Specification subject to change without notice. 本公司有權針對以上數據規格進行設計變更不先行告知。

PT-FS Double Stage Dims. 雙段外型尺寸圖

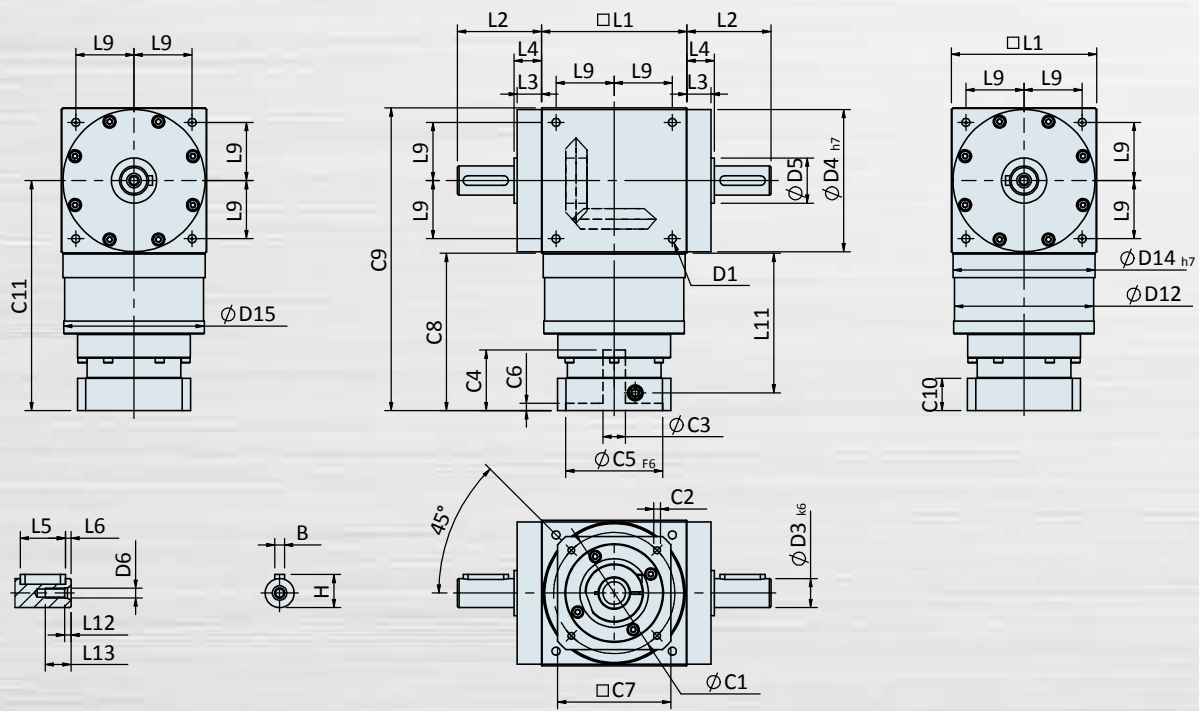

Specifications 規格

Unit: mm

| Dims. 尺寸 | PT60-FS | PT75-FS | PT90-FS | PT110-FS | PT140-FS | PT170-FS | PT210-FS |
|--------------------|------------|---------|------------|-------------|-------------|--------------|----------|
| D1 | 24-M4x0.7P | - | 24-M6x1.0P | 24-M8x1.25P | 24-M10x1.5P | 24-M12x1.75P | - |
| D2 | - | - | - | - | - | - | - |
| D3 _{k6} | 13 | - | 18 | 22 | 32 | 40 | - |
| D4 _{h7} | 60 | - | 88 | 108 | 135 | 165 | - |
| D5 | 21 | - | 28 | 33 | 47 | 55 | - |
| D6 | M4x0.7P | - | M6x1.0P | M8x1.25P | M12x1.75P | M16x2.0P | - |
| D7 | - | - | - | - | - | - | - |
| D12 | 59.8 | - | 86 | 106 | 104 | 128 | - |
| D14 _{h7} | 60.2 | - | 88 | 108 | 135 | 165 | - |
| D15 | 60 | - | 87 | 107 | 103 | 127 | - |
| L1 | 60.8 | - | 90 | 110 | 140 | 170 | - |
| L2 | 31.5 | - | 52 | 57 | 67 | 77 | - |
| L3 | 10 | - | 15 | 15 | 15 | 15 | - |
| L4 | 12 | - | 17 | 17 | 17 | 17 | - |
| L5 | 16 | - | 28 | 32 | 45 | 50 | - |
| L6 | 2 | - | 3.5 | 4 | 2.5 | 5 | - |
| L7 | - | - | - | - | - | - | - |
| L9 | 24.75 | - | 36 | 44 | 55 | 67 | - |
| L10 | - | - | - | - | - | - | - |
| L11 | 63.7 | - | 86.4 | 104.8 | 120.8 | 114.8 | - |
| L12 | 4 | - | 4 | 4.5 | 6 | 6 | - |
| L13 | 12 | - | 16 | 20.5 | 30 | 36 | - |
| C1 ¹ | 46 | - | 70 | 90 | 90 | 90 | - |
| C2 ¹ | M4x0.7P | - | M5x0.8P | M6x1.0P | M6x1.0P | M6x1.0P | - |
| C3 ¹ | ≤8/≤11 | - | ≤14/≤19 | ≤24 | ≤24 | ≤24 | - |
| C4 ¹ | 28.6 | - | 37.5 | 48.2 | 48.2 | 48.2 | - |
| C5 ¹ F6 | 30 | - | 50 | 70 | 70 | 70 | - |
| C6 ¹ | 4.1 | - | 4.5 | 6 | 6 | 6 | - |
| C7 ¹ | 42 | - | 60 | 90 | 90 | 90 | - |
| C8 ¹ | 73.3 | - | 97.4 | 119.5 | 135.5 | 129.5 | - |
| C9 ¹ | 134.1 | - | 187.4 | 229.5 | 275.5 | 299.5 | - |
| C10 ¹ | 17 | - | 20 | 26 | 26 | 26 | - |
| C11 ¹ | 103.7 | - | 142.4 | 174.5 | 205.5 | 214.5 | - |
| B | 5 | - | 6 | 6 | 10 | 12 | - |
| H | 15 | - | 20.5 | 24.5 | 35 | 43 | - |

*1. C1~C11 are motor specific dimensions (metric std shown), size may vary according to motor flange. C1~C11是公製標準馬達連接板尺寸，請依所選用的馬達決定。
 ★ Specification subject to change without notice. 本公司有權針對以上數據規格逕行設計變更不先行告知。

PT-FS Triple Stage Dims. 三段外型尺寸圖

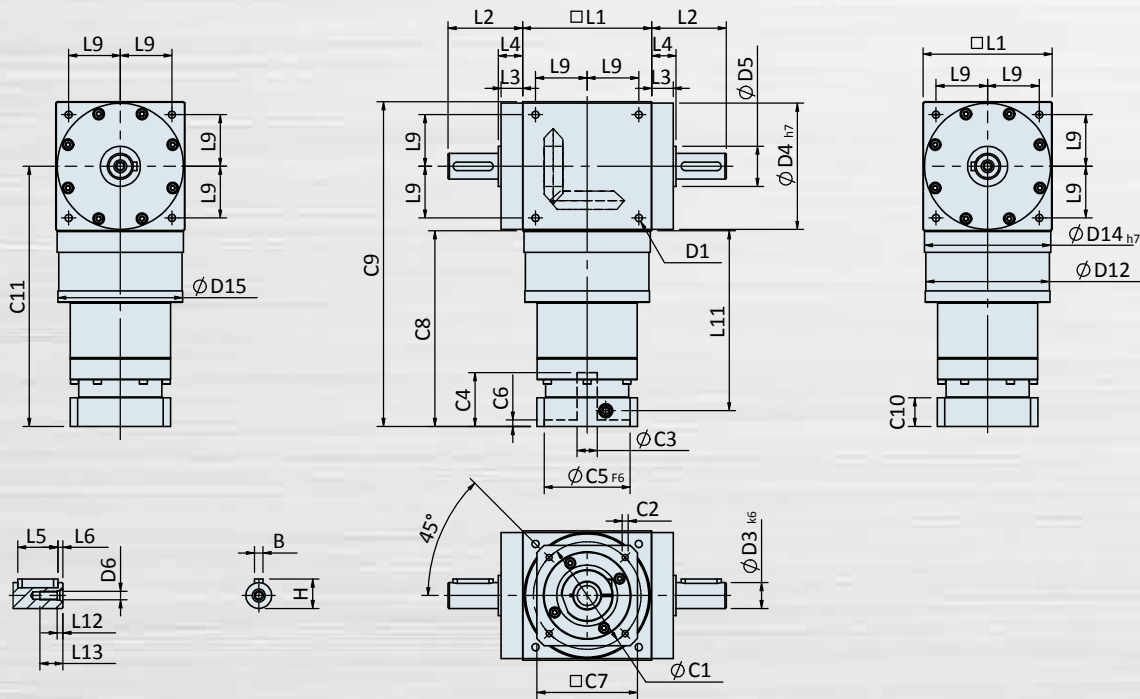

Specifications 規格

Unit: mm

| Dims. 尺寸 | PT60-FS | PT75-FS | PT90-FS | PT110-FS | PT140-FS | PT170-FS | PT210-FS |
|-------------------------------|---------|---------|-------------------|-------------|-------------|--------------|----------|
| D1 | - | - | 24-M6x1.0P | 24-M8x1.25P | 24-M10x1.5P | 24-M12x1.75P | - |
| D2 | - | - | - | - | - | - | - |
| D3 _{k6} | - | - | 18 | 22 | 32 | 40 | - |
| D4 _{h7} | - | - | 88 | 108 | 135 | 165 | - |
| D5 | - | - | 28 | 33 | 47 | 55 | - |
| D6 | - | - | M6x1.0P | M8x1.25P | M12x1.75P | M16x2.0P | - |
| D7 | - | - | - | - | - | - | - |
| D12 | - | - | 86 | 106 | 104 | 128 | - |
| D14 _{h7} | - | - | 88 | 108 | 135 | 165 | - |
| D15 | - | - | 87 | 107 | 103 | 127 | - |
| L1 | - | - | 90 | 110 | 140 | 170 | - |
| L2 | - | - | 52 | 57 | 67 | 77 | - |
| L3 | - | - | 15 | 15 | 15 | 15 | - |
| L4 | - | - | 17 | 17 | 17 | 17 | - |
| L5 | - | - | 28 | 32 | 45 | 50 | - |
| L6 | - | - | 3.5 | 4 | 2.5 | 5 | - |
| L7 | - | - | - | - | - | - | - |
| L9 | - | - | 36 | 44 | 55 | 67 | - |
| L10 | - | - | - | - | - | - | - |
| L11 | - | - | 86.4 | 149.8 | 165.8 | 159.8 | - |
| L12 | - | - | 4 | 4.5 | 6 | 6 | - |
| L13 | - | - | 16 | 20.5 | 30 | 36 | - |
| C1 ¹ | - | - | 70 | 90 | 90 | 90 | - |
| C2 ¹ | - | - | M5x0.8P | M6x1.0P | M6x1.0P | M6x1.0P | - |
| C3 ¹ | - | - | $\leq 14/\leq 19$ | ≤ 24 | ≤ 24 | ≤ 24 | - |
| C4 ¹ | - | - | 37.5 | 48.2 | 48.2 | 48.2 | - |
| C5 ¹ _{F6} | - | - | 50 | 70 | 70 | 70 | - |
| C6 ¹ | - | - | 4.5 | 6 | 6 | 6 | - |
| C7 ¹ | - | - | 60 | 90 | 90 | 90 | - |
| C8 ¹ | - | - | 97.4 | 164.5 | 180.5 | 174.5 | - |
| C9 ¹ | - | - | 187.4 | 274.5 | 320.5 | 344.5 | - |
| C10 ¹ | - | - | 20 | 26 | 26 | 26 | - |
| C11 ¹ | - | - | 142.4 | 219.5 | 250.5 | 259.5 | - |
| B | - | - | 6 | 6 | 10 | 12 | - |
| H | - | - | 20.5 | 24.5 | 35 | 43 | - |

*1. C1~C11 are motor specific dimensions (metric std shown), size may vary according to motor flange. C1~C11是公製標準馬達連接板尺寸，請依所選用的馬達決定。
 ★ Specification subject to change without notice. 本公司有權針對以上數據規格逕行設計變更不先行告知。

PT-FSR Single Stage Dims. 單段外型尺寸圖

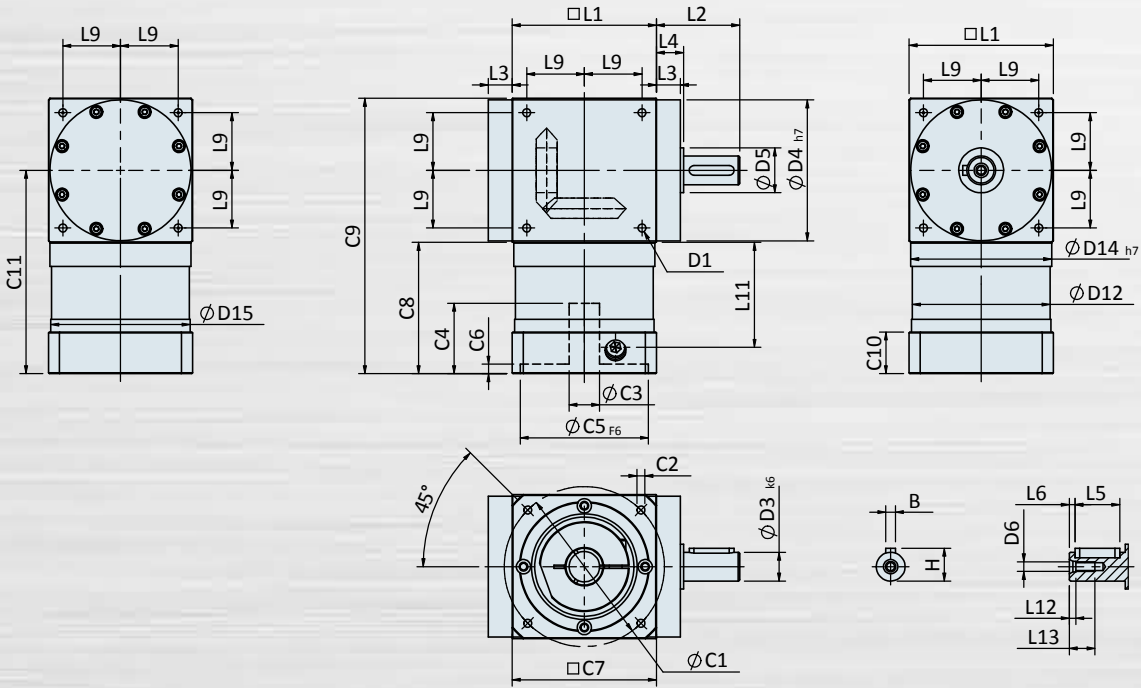

Specifications 規格

Unit: mm

| Dims. 尺寸 | PT60-FSR | PT75-FSR | PT90-FSR | PT110-FSR | PT140-FSR | PT170-FSR | PT210-FSR |
|-------------------------------|-------------------------------|----------|---------------------|-------------|-------------|--------------|-----------|
| D1 | 24-M4x0.7P | - | 24-M6x1.0P | 24-M8x1.25P | 24-M10x1.5P | 24-M12x1.75P | - |
| D2 | - | - | - | - | - | - | - |
| D3 _{k6} | 13 | - | 18 | 22 | 32 | 40 | - |
| D4 _{h7} | 60 | - | 88 | 108 | 135 | 165 | - |
| D5 | 21 | - | 28 | 33 | 47 | 55 | - |
| D6 | M4x0.7P | - | M6x1.0P | M8x1.25P | M12x1.75P | M16x2.0P | - |
| D7 | - | - | - | - | - | - | - |
| D12 | 60 | - | 86 | 106 | 104 | 128 | - |
| D14 _{h7} | 60.2 | - | 88 | 108 | 135 | 165 | - |
| D15 | 41.8 | - | 87 | 107 | 103 | 127 | - |
| L1 | 60.8 | - | 90 | 110 | 140 | 170 | - |
| L2 | 31.5 | - | 52 | 57 | 67 | 77 | - |
| L3 | 10 | - | 15 | 15 | 15 | 15 | - |
| L4 | 12 | - | 17 | 17 | 17 | 17 | - |
| L5 | 16 | - | 28 | 32 | 45 | 50 | - |
| L6 | 2 | - | 3.5 | 4 | 2.5 | 5 | - |
| L7 | - | - | - | - | - | - | - |
| L9 | 24.75 | - | 36 | 44 | 55 | 67 | - |
| L10 | - | - | - | - | - | - | - |
| L11 | 38.2 | - | 65.5 | 77 | 86.4 | 94.1 | - |
| L12 | 4 | - | 4 | 4.5 | 6 | 6 | - |
| L13 | 12 | - | 16 | 20.5 | 30 | 36 | - |
| C1 ¹ | 46 | - | 100 | 100 | 130 | 165 | - |
| C2 ¹ | M4x0.7P | - | M6x1.0P | M6x1.0P | M8x1.25P | M10x1.5P | - |
| C3 ¹ | $\leq 11 / \leq 14 / \leq 19$ | - | $\leq 19 / \leq 24$ | ≤ 24 | ≤ 32 | ≤ 38 | - |
| C4 ¹ | 33 | - | 44 | 47 | 55.1 | 67 | - |
| C5 ¹ _{F6} | 30 | - | 80 | 80 | 110 | 130 | - |
| C6 ¹ | 4 | - | 6 | 5 | 5 | 6 | - |
| C7 ¹ | 42.6 | - | 90 | 90 | 115 | 140 | - |
| C8 ¹ | 47.2 | - | 82 | 93 | 106 | 118 | - |
| C9 ¹ | 108 | - | 172 | 203 | 246 | 288 | - |
| C10 ¹ | 18.5 | - | 26 | 23 | 27 | 35 | - |
| C11 ¹ | 77.6 | - | 127 | 148 | 176 | 203 | - |
| B | 5 | - | 6 | 6 | 10 | 12 | - |
| H | 15 | - | 20.5 | 24.5 | 35 | 43 | - |

*1. C1~C11 are motor specific dimensions (metric std shown), size may vary according to motor flange. C1~C11是公製標準馬達連接板尺寸，請依所選用的馬達決定。
 ★ Specification subject to change without notice. 本公司有權針對以上數據規格逕行設計變更不先行告知。

PT-FSR Double Stage Dims. 雙段外型尺寸圖

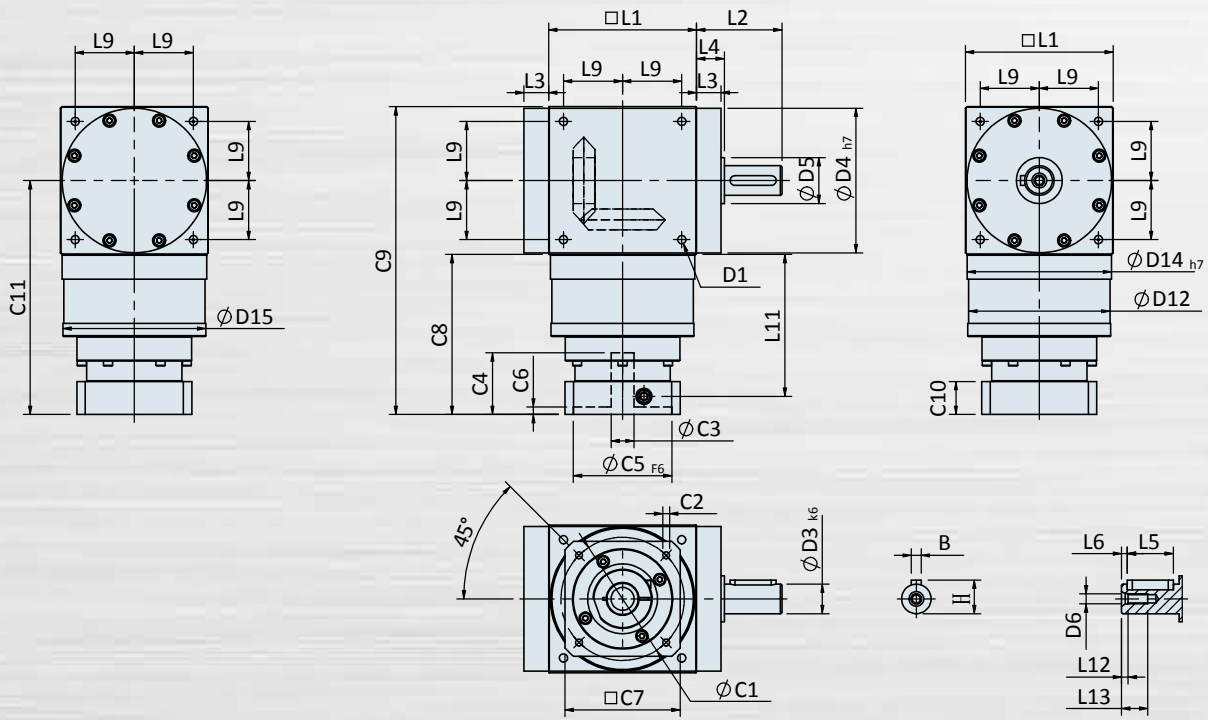

Specifications 規格

Unit: mm

| Dims. 尺寸 | PT60-FSR | PT75-FSR | PT90-FSR | PT110-FSR | PT140-FSR | PT170-FSR | PT210-FSR |
|--------------------|------------|----------|------------|-------------|-------------|--------------|-----------|
| D1 | 24-M4x0.7P | - | 24-M6x1.0P | 24-M8x1.25P | 24-M10x1.5P | 24-M12x1.75P | - |
| D2 | - | - | - | - | - | - | - |
| D3 _{k6} | 13 | - | 18 | 22 | 32 | 40 | - |
| D4 _{h7} | 60 | - | 88 | 108 | 135 | 165 | - |
| D5 | 21 | - | 28 | 33 | 47 | 55 | - |
| D6 | M4x0.7P | - | M6x1.0P | M8x1.25P | M12x1.75P | M16x2.0P | - |
| D7 | - | - | - | - | - | - | - |
| D12 | 59.8 | - | 86 | 106 | 104 | 128 | - |
| D14 _{h7} | 60.2 | - | 88 | 108 | 135 | 165 | - |
| D15 | 60 | - | 87 | 107 | 103 | 127 | - |
| L1 | 60.8 | - | 90 | 110 | 140 | 170 | - |
| L2 | 31.5 | - | 52 | 57 | 67 | 77 | - |
| L3 | 10 | - | 15 | 15 | 15 | 15 | - |
| L4 | 12 | - | 17 | 17 | 17 | 17 | - |
| L5 | 16 | - | 28 | 32 | 45 | 50 | - |
| L6 | 2 | - | 3.5 | 4 | 2.5 | 5 | - |
| L7 | - | - | - | - | - | - | - |
| L9 | 24.75 | - | 36 | 44 | 55 | 67 | - |
| L10 | - | - | - | - | - | - | - |
| L11 | 63.7 | - | 86.4 | 104.8 | 120.8 | 114.8 | - |
| L12 | 4 | - | 4 | 4.5 | 6 | 6 | - |
| L13 | 12 | - | 16 | 20.5 | 30 | 36 | - |
| C1 ¹ | 46 | - | 70 | 90 | 90 | 90 | - |
| C2 ¹ | M4x0.7P | - | M5x0.8P | M6x1.0P | M6x1.0P | M6x1.0P | - |
| C3 ¹ | ≤8/≤11 | - | ≤14/≤19 | ≤24 | ≤24 | ≤24 | - |
| C4 ¹ | 28.6 | - | 37.5 | 48.2 | 48.2 | 48.2 | - |
| C5 ¹ F6 | 30 | - | 50 | 70 | 70 | 70 | - |
| C6 ¹ | 4.1 | - | 4.5 | 6 | 6 | 6 | - |
| C7 ¹ | 42 | - | 60 | 90 | 90 | 90 | - |
| C8 ¹ | 73.3 | - | 97.4 | 119.5 | 135.5 | 129.5 | - |
| C9 ¹ | 134.1 | - | 187.4 | 229.5 | 275.5 | 299.5 | - |
| C10 ¹ | 17 | - | 20 | 26 | 26 | 26 | - |
| C11 ¹ | 103.7 | - | 142.4 | 174.5 | 205.5 | 214.5 | - |
| B | 5 | - | 6 | 6 | 10 | 12 | - |
| H | 15 | - | 20.5 | 24.5 | 35 | 43 | - |

*1. C1~C11 are motor specific dimensions (metric std shown), size may vary according to motor flange. C1~C11是公製標準馬達連接板尺寸，請依所選用的馬達決定。
 ★ Specification subject to change without notice. 本公司有權針對以上數據規格逕行設計變更不先行告知。

PT-FSR Triple Stage Dims. 三段外型尺寸圖

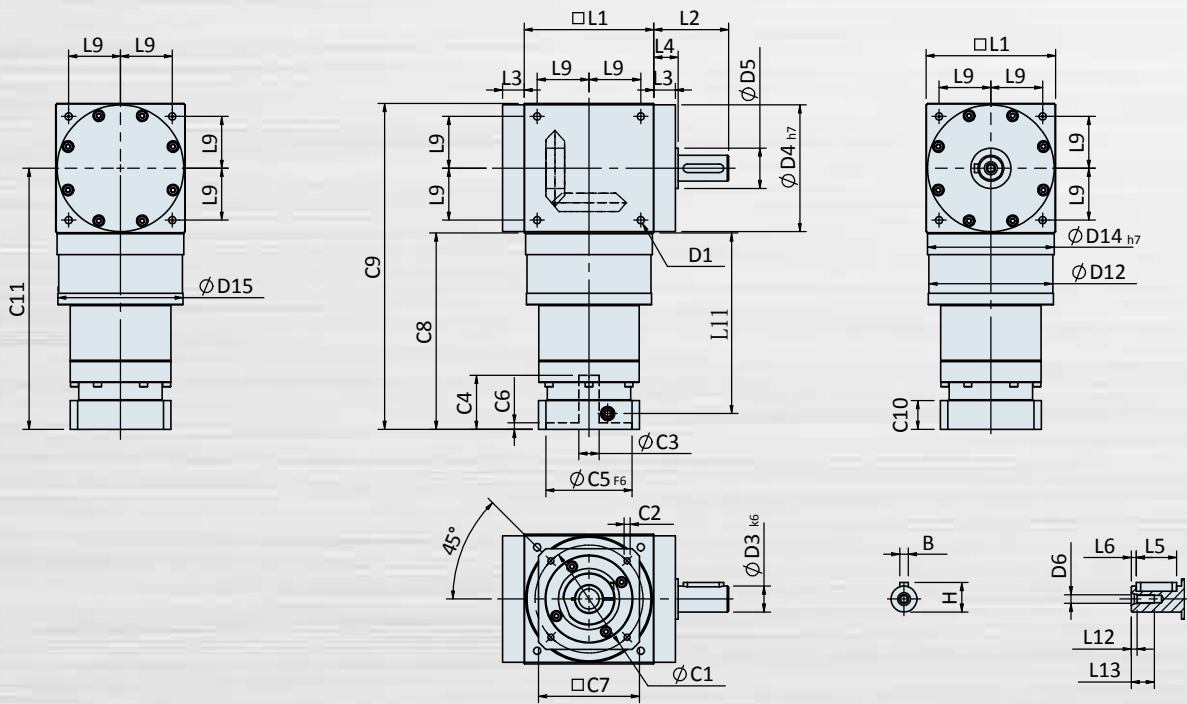

Specifications 規格

Unit: mm

| Dims. 尺寸 | PT60-FSR | PT75-FSR | PT90-FSR | PT110-FSR | PT140-FSR | PT170-FSR | PT210-FSR |
|--------------------|----------|----------|----------|-------------|-------------|--------------|-----------|
| D1 | - | - | - | 24-M8x1.25P | 24-M10x1.5P | 24-M12x1.75P | - |
| D2 | - | - | - | - | - | - | - |
| D3 _{k6} | - | - | - | 22 | 32 | 40 | - |
| D4 _{h7} | - | - | - | 108 | 135 | 165 | - |
| D5 | - | - | - | 33 | 47 | 55 | - |
| D6 | - | - | - | M8x1.25P | M12x1.75P | M16x2.0P | - |
| D7 | - | - | - | - | - | - | - |
| D12 | - | - | - | 106 | 104 | 128 | - |
| D14 _{h7} | - | - | - | 108 | 135 | 165 | - |
| D15 | - | - | - | 107 | 103 | 127 | - |
| L1 | - | - | - | 110 | 140 | 170 | - |
| L2 | - | - | - | 57 | 67 | 77 | - |
| L3 | - | - | - | 15 | 15 | 15 | - |
| L4 | - | - | - | 17 | 17 | 17 | - |
| L5 | - | - | - | 32 | 45 | 50 | - |
| L6 | - | - | - | 4 | 2.5 | 5 | - |
| L7 | - | - | - | - | - | - | - |
| L9 | - | - | - | 44 | 55 | 67 | - |
| L10 | - | - | - | - | - | - | - |
| L11 | - | - | - | 149.8 | 165.8 | 159.8 | - |
| L12 | - | - | - | 4.5 | 6 | 6 | - |
| L13 | - | - | - | 20.5 | 30 | 36 | - |
| C1 ¹ | - | - | - | 90 | 90 | 90 | - |
| C2 ¹ | - | - | - | M6x1.0P | M6x1.0P | M6x1.0P | - |
| C3 ¹ | - | - | - | ≤24 | ≤24 | ≤24 | - |
| C4 ¹ | - | - | - | 48.2 | 48.2 | 48.2 | - |
| C5 ¹ | - | - | - | 70 | 70 | 70 | - |
| C6 ¹ F6 | - | - | - | 6 | 6 | 6 | - |
| C7 ¹ | - | - | - | 90 | 90 | 90 | - |
| C8 ¹ | - | - | - | 164.5 | 180.5 | 174.5 | - |
| C9 ¹ | - | - | - | 274.5 | 320.5 | 344.5 | - |
| C10 ¹ | - | - | - | 26 | 26 | 26 | - |
| C11 ¹ | - | - | - | 219.5 | 250.5 | 259.5 | - |
| B | - | - | - | 6 | 10 | 12 | - |
| H | - | - | - | 24.5 | 35 | 43 | - |

*1. C1~C11 are motor specific dimensions (metric std shown), size may vary according to motor flange. C1~C11是公製標準馬達連接板尺寸，請依所選用的馬達決定。
 ★ Specification subject to change without notice. 本公司有權針對以上數據規格進行設計變更不先行告知。

PT-FSL Single Stage Dims. 單段外型尺寸圖

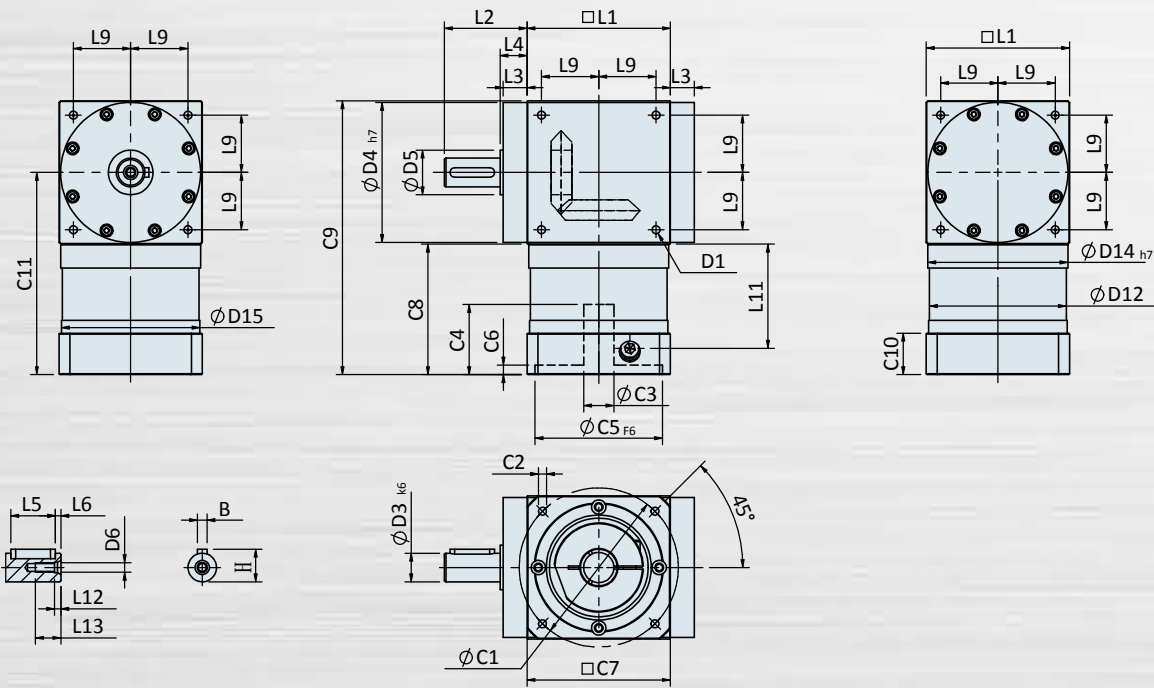

Specifications 規格

Unit: mm

| Dims. 尺寸 | PT60-FSL | PT75-FSL | PT90-FSL | PT110-FSL | PT140-FSL | PT170-FSL | PT210-FSL |
|--------------------|---------------------------|----------|-------------------|-------------|-------------|--------------|-----------|
| D1 | 24-M4x0.7P | - | 24-M6x1.0P | 24-M8x1.25P | 24-M10x1.5P | 24-M12x1.75P | - |
| D2 | - | - | - | - | - | - | - |
| D3 _{k6} | 13 | - | 18 | 22 | 32 | 40 | - |
| D4 _{h7} | 60 | - | 88 | 108 | 135 | 165 | - |
| D5 | 21 | - | 28 | 33 | 47 | 55 | - |
| D6 | M4x0.7P | - | M6x1.0P | M8x1.25P | M12x1.75P | M16x2.0P | - |
| D7 | - | - | - | - | - | - | - |
| D12 | 60 | - | 86 | 106 | 104 | 128 | - |
| D14 _{h7} | 60.2 | - | 88 | 108 | 135 | 165 | - |
| D15 | 41.8 | - | 87 | 107 | 103 | 127 | - |
| L1 | 60.8 | - | 90 | 110 | 140 | 170 | - |
| L2 | 31.5 | - | 52 | 57 | 67 | 77 | - |
| L3 | 10 | - | 15 | 15 | 15 | 15 | - |
| L4 | 12 | - | 17 | 17 | 17 | 17 | - |
| L5 | 16 | - | 28 | 32 | 45 | 50 | - |
| L6 | 2 | - | 3.5 | 4 | 2.5 | 5 | - |
| L7 | - | - | - | - | - | - | - |
| L9 | 24.75 | - | 36 | 44 | 55 | 67 | - |
| L10 | - | - | - | - | - | - | - |
| L11 | 38.2 | - | 65.5 | 77 | 86.4 | 94.1 | - |
| L12 | 4 | - | 4 | 4.5 | 6 | 6 | - |
| L13 | 12 | - | 16 | 20.5 | 30 | 36 | - |
| C1 ¹ | 46 | - | 100 | 100 | 130 | 165 | - |
| C2 ¹ | M4x0.7P | - | M6x1.0P | M6x1.0P | M8x1.25P | M10x1.5P | - |
| C3 ¹ | $\leq 11/\leq 14/\leq 19$ | - | $\leq 19/\leq 24$ | ≤ 24 | ≤ 32 | ≤ 38 | - |
| C4 ¹ | 33 | - | 44 | 47 | 55.1 | 67 | - |
| C5 ¹ F6 | 30 | - | 80 | 80 | 110 | 130 | - |
| C6 ¹ | 4 | - | 6 | 5 | 5 | 6 | - |
| C7 ¹ | 42.6 | - | 90 | 90 | 115 | 140 | - |
| C8 ¹ | 47.2 | - | 82 | 93 | 106 | 118 | - |
| C9 ¹ | 108 | - | 172 | 203 | 246 | 288 | - |
| C10 ¹ | 18.5 | - | 26 | 23 | 27 | 35 | - |
| C11 ¹ | 77.6 | - | 127 | 148 | 176 | 203 | - |
| B | 5 | - | 6 | 6 | 10 | 12 | - |
| H | 15 | - | 20.5 | 24.5 | 35 | 43 | - |

*1. C1~C11 are motor specific dimensions (metric std shown), size may vary according to motor flange. C1~C11是公製標準馬達連接板尺寸，請依所選用的馬達決定。
 ★ Specification subject to change without notice. 本公司有權針對以上數據規格進行設計變更不先行告知。

PT-FSL Double Stage Dims. 雙段外型尺寸圖

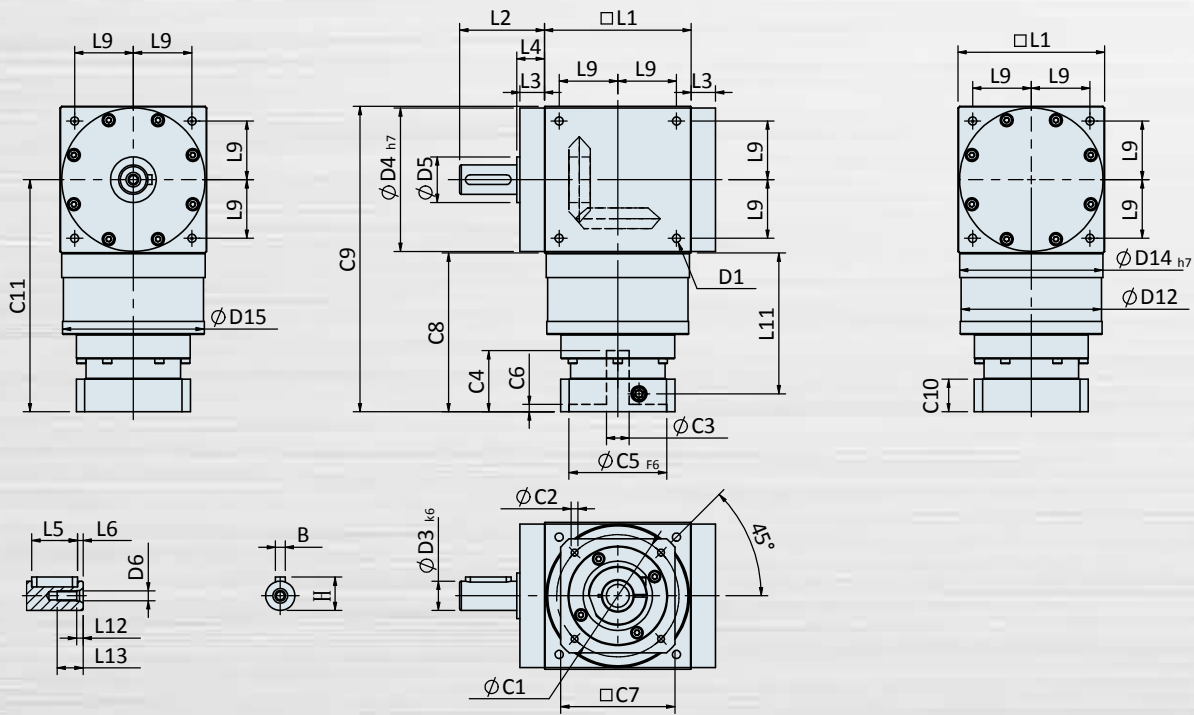

Specifications 規格

Unit: mm

| Dims. 尺寸 | PT60-FSL | PT75-FSL | PT90-FSL | PT110-FSL | PT140-FSL | PT170-FSL | PT210-FSL |
|-------------------------------|------------------|----------|-------------------|-------------|-------------|--------------|-----------|
| D1 | 24-M4x0.7P | - | 24-M6x1.0P | 24-M8x1.25P | 24-M10x1.5P | 24-M12x1.75P | - |
| D2 | - | - | - | - | - | - | - |
| D3 _{k6} | 13 | - | 18 | 22 | 32 | 40 | - |
| D4 _{h7} | 60 | - | 88 | 108 | 135 | 165 | - |
| D5 | 21 | - | 28 | 33 | 47 | 55 | - |
| D6 | M4x0.7P | - | M6x1.0P | M8x1.25P | M12x1.75P | M16x2.0P | - |
| D7 | - | - | - | - | - | - | - |
| D12 | 59.8 | - | 86 | 106 | 104 | 128 | - |
| D14 _{h7} | 60.2 | - | 88 | 108 | 135 | 165 | - |
| D15 | 60 | - | 87 | 107 | 103 | 127 | - |
| L1 | 60.8 | - | 90 | 110 | 140 | 170 | - |
| L2 | 31.5 | - | 52 | 57 | 67 | 77 | - |
| L3 | 10 | - | 15 | 15 | 15 | 15 | - |
| L4 | 12 | - | 17 | 17 | 17 | 17 | - |
| L5 | 16 | - | 28 | 32 | 45 | 50 | - |
| L6 | 2 | - | 3.5 | 4 | 2.5 | 5 | - |
| L7 | - | - | - | - | - | - | - |
| L9 | 24.75 | - | 36 | 44 | 55 | 67 | - |
| L10 | - | - | - | - | - | - | - |
| L11 | 63.7 | - | 86.4 | 104.8 | 120.8 | 114.8 | - |
| L12 | 4 | - | 4 | 4.5 | 6 | 6 | - |
| L13 | 12 | - | 16 | 20.5 | 30 | 36 | - |
| C1 ¹ | 46 | - | 70 | 90 | 90 | 90 | - |
| C2 ¹ | M4x0.7P | - | M5x0.8P | M6x1.0P | M6x1.0P | M6x1.0P | - |
| C3 ¹ | $\leq 8/\leq 11$ | - | $\leq 14/\leq 19$ | ≤ 24 | ≤ 24 | ≤ 24 | - |
| C4 ¹ | 28.6 | - | 37.5 | 48.2 | 48.2 | 48.2 | - |
| C5 ¹ _{F6} | 30 | - | 50 | 70 | 70 | 70 | - |
| C6 ¹ | 4.1 | - | 4.5 | 6 | 6 | 6 | - |
| C7 ¹ | 42 | - | 60 | 90 | 90 | 90 | - |
| C8 ¹ | 73.3 | - | 97.4 | 119.5 | 135.5 | 129.5 | - |
| C9 ¹ | 134.1 | - | 187.4 | 229.5 | 275.5 | 299.5 | - |
| C10 ¹ | 17 | - | 20 | 26 | 26 | 26 | - |
| C11 ¹ | 103.7 | - | 142.4 | 174.5 | 205.5 | 214.5 | - |
| B | 5 | - | 6 | 6 | 10 | 12 | - |
| H | 15 | - | 20.5 | 24.5 | 35 | 43 | - |

*1. C1~C11 are motor specific dimensions (metric std shown), size may vary according to motor flange. C1~C11是公製標準馬達連接板尺寸，請依所選用的馬達決定。
 * Specification subject to change without notice. 本公司有權針對以上數據規格進行設計變更不先行告知。

PT-FSL Triple Stage Dims. 三段外型尺寸圖

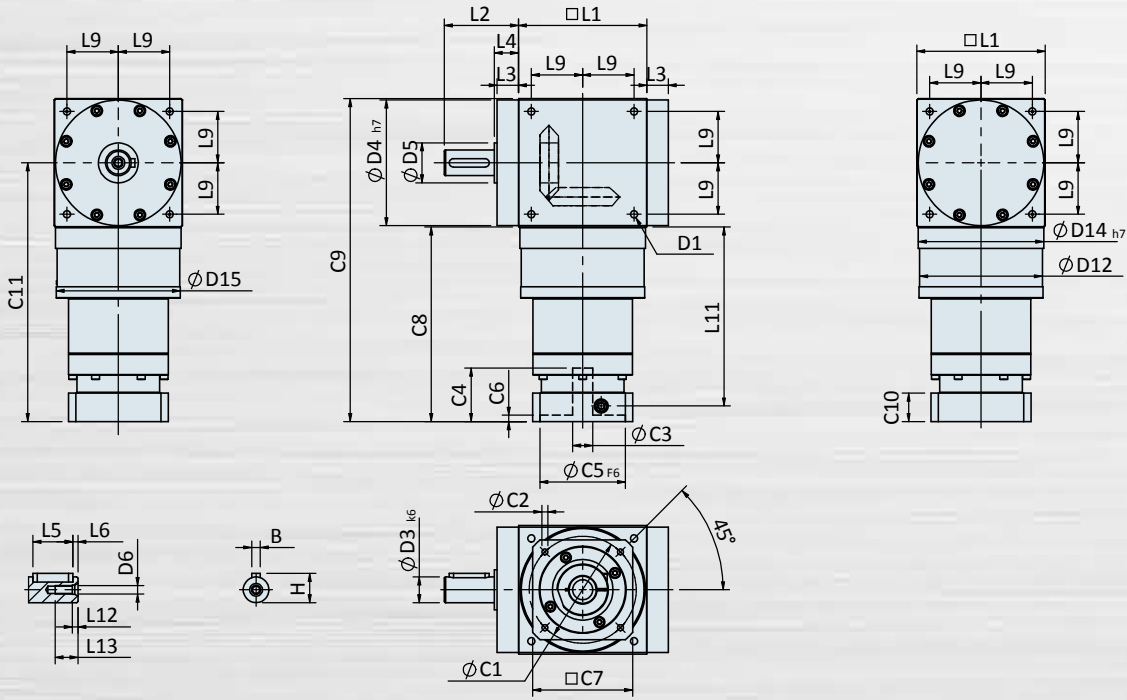

Specifications 規格

Unit: mm

| Dims. 尺寸 | PT60-FSL | PT75-FSL | PT90-FSL | PT110-FSL | PT140-FSL | PT170-FSL | PT210-FSL |
|--------------------|----------|----------|----------|-------------|-------------|--------------|-----------|
| D1 | - | - | - | 24-M8x1.25P | 24-M10x1.5P | 24-M12x1.75P | - |
| D2 | - | - | - | - | - | - | - |
| D3 _{k6} | - | - | - | 22 | 32 | 40 | - |
| D4 _{h7} | - | - | - | 108 | 135 | 165 | - |
| D5 | - | - | - | 33 | 47 | 55 | - |
| D6 | - | - | - | M8x1.25P | M12x1.75P | M16x2.0P | - |
| D7 | - | - | - | - | - | - | - |
| D12 | - | - | - | 106 | 104 | 128 | - |
| D14 _{h7} | - | - | - | 108 | 135 | 165 | - |
| D15 | - | - | - | 107 | 103 | 127 | - |
| L1 | - | - | - | 110 | 140 | 170 | - |
| L2 | - | - | - | 57 | 67 | 77 | - |
| L3 | - | - | - | 15 | 15 | 15 | - |
| L4 | - | - | - | 17 | 17 | 17 | - |
| L5 | - | - | - | 32 | 45 | 50 | - |
| L6 | - | - | - | 4 | 2.5 | 5 | - |
| L7 | - | - | - | - | - | - | - |
| L9 | - | - | - | 44 | 55 | 67 | - |
| L10 | - | - | - | - | - | - | - |
| L11 | - | - | - | 149.8 | 165.8 | 159.8 | - |
| L12 | - | - | - | 4.5 | 6 | 6 | - |
| L13 | - | - | - | 20.5 | 30 | 36 | - |
| C1 ¹ | - | - | - | 90 | 90 | 90 | - |
| C2 ¹ | - | - | - | M6x1.0P | M6x1.0P | M6x1.0P | - |
| C3 ¹ | - | - | - | ≤24 | ≤24 | ≤24 | - |
| C4 ¹ | - | - | - | 48.2 | 48.2 | 48.2 | - |
| C5 ¹ F6 | - | - | - | 70 | 70 | 70 | - |
| C6 ¹ | - | - | - | 6 | 6 | 6 | - |
| C7 ¹ | - | - | - | 90 | 90 | 90 | - |
| C8 ¹ | - | - | - | 164.5 | 180.5 | 174.5 | - |
| C9 ¹ | - | - | - | 274.5 | 320.5 | 344.5 | - |
| C10 ¹ | - | - | - | 26 | 26 | 26 | - |
| C11 ¹ | - | - | - | 219.5 | 250.5 | 259.5 | - |
| B | - | - | - | 6 | 10 | 12 | - |
| H | - | - | - | 24.5 | 35 | 43 | - |

*1. C1~C11 are motor specific dimensions (metric std shown), size may vary according to motor flange. C1~C11是公製標準馬達連接板尺寸，請依所選用的馬達決定。
 ★ Specification subject to change without notice. 本公司有權針對以上數據規格逕行設計變更不先行告知。

PT-FH Single Stage Dims. 單段外型尺寸圖

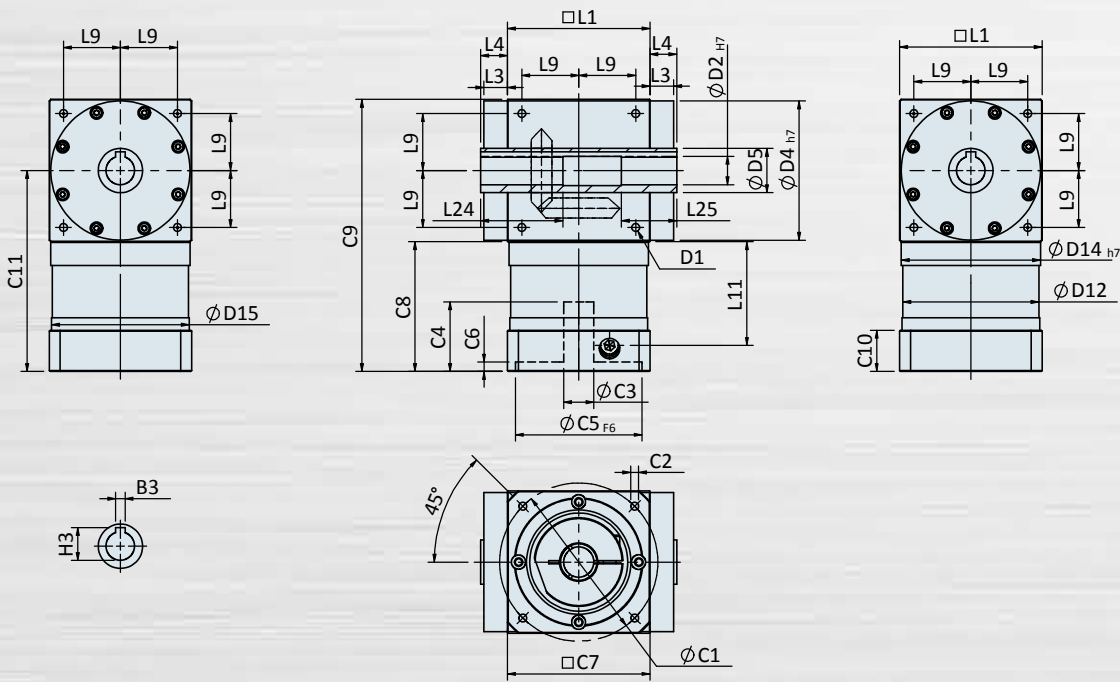

Specifications 規格

Unit: mm

| Dims. 尺寸 | PT60-FH | PT75-FH | PT90-FH | PT110-FH | PT140-FH | PT170-FH | PT210-FH |
|--------------------|-------------|---------|------------|-------------|-------------|--------------|----------|
| D1 | 24-M4x0.7P | - | 24-M6x1.0P | 24-M8x1.25P | 24-M10x1.5P | 24-M12x1.75P | - |
| D2 _{H7} | 13 | - | 18 | 22 | 32 | 40 | - |
| D3 _{k6} | - | - | - | - | - | - | - |
| D4 _{H7} | 60 | - | 88 | 108 | 135 | 165 | - |
| D5 | 21 | - | 28 | 33 | 47 | 55 | - |
| D6 | - | - | - | - | - | - | - |
| D7 | - | - | - | - | - | - | - |
| D12 | 60 | - | 86 | 106 | 104 | 128 | - |
| D14 _{H7} | 60.2 | - | 88 | 108 | 135 | 165 | - |
| D15 | 41.8 | - | 87 | 107 | 103 | 127 | - |
| L1 | 60.8 | - | 90 | 110 | 140 | 170 | - |
| L2 | - | - | - | - | - | - | - |
| L3 | 10 | - | 15 | 15 | 15 | 15 | - |
| L4 | 12 | - | 17 | 17 | 17 | 17 | - |
| L5 | - | - | - | - | - | - | - |
| L6 | - | - | - | - | - | - | - |
| L7 | - | - | - | - | - | - | - |
| L9 | 24.75 | - | 36 | 44 | 55 | 67 | - |
| L10 | - | - | - | - | - | - | - |
| L11 | 38.2 | - | 65.5 | 77 | 86.4 | 94.1 | - |
| L24 | 40 | - | 52 | 53 | 70 | 80 | - |
| L25 | 30 | - | 35 | 35 | 50 | 55 | - |
| C1 ¹ | 46 | - | 100 | 100 | 130 | 165 | - |
| C2 ¹ | M4x0.7P | - | M6x1.0P | M6x1.0P | M8x1.25P | M10x1.5P | - |
| C3 ¹ | ≤11/≤14/≤19 | - | ≤19/≤24 | ≤24 | ≤32 | ≤38 | - |
| C4 ¹ | 33 | - | 44 | 47 | 55.1 | 67 | - |
| C5 ¹ F6 | 30 | - | 80 | 80 | 110 | 130 | - |
| C6 ¹ | 4 | - | 6 | 5 | 5 | 6 | - |
| C7 ¹ | 42.6 | - | 90 | 90 | 115 | 140 | - |
| C8 ¹ | 47.2 | - | 82 | 93 | 106 | 118 | - |
| C9 ¹ | 108 | - | 172 | 203 | 246 | 288 | - |
| C10 ¹ | 18.5 | - | 26 | 23 | 27 | 35 | - |
| C11 ¹ | 77.6 | - | 127 | 148 | 176 | 203 | - |
| B3 | 5 | - | 6 | 6 | 10 | 12 | - |
| H3 | 15.3 | - | 20.8 | 24.8 | 35.3 | 43.3 | - |

*1. C1~C11 are motor specific dimensions (metric std shown), size may vary according to motor flange. C1~C11是公製標準馬達連接板尺寸，請依所選用的馬達決定。
 ★ Specification subject to change without notice. 本公司有權針對以上數據規格逕行設計變更不先行告知。

PT-FH Double Stage Dims. 雙段外型尺寸圖

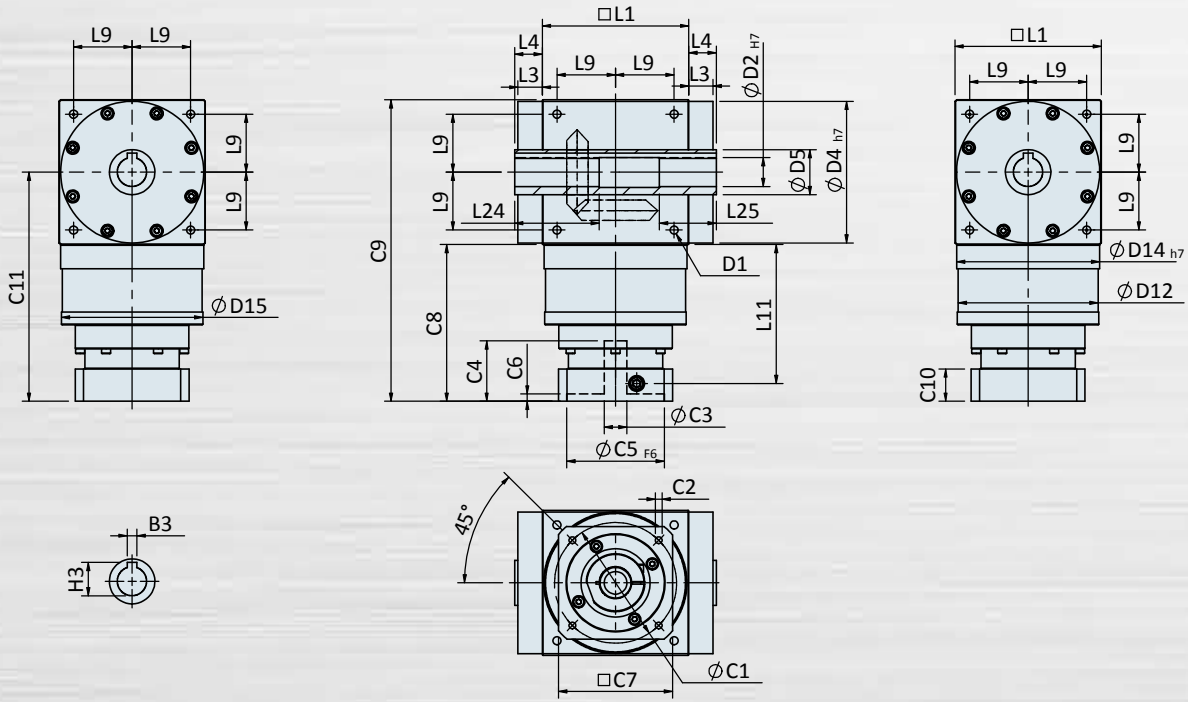

Specifications 規格

Unit: mm

| Dims. 尺寸 | PT60-FH | PT75-FH | PT90-FH | PT110-FH | PT140-FH | PT170-FH | PT210-FH |
|--------------------|------------|---------|------------|-------------|-------------|--------------|----------|
| D1 | 24-M4x0.7P | - | 24-M6x1.0P | 24-M8x1.25P | 24-M10x1.5P | 24-M12x1.75P | - |
| D2 | 13 | - | 18 | 22 | 32 | 40 | - |
| D3 _{k6} | - | - | - | - | - | - | - |
| D4 _{h7} | 60 | - | 88 | 108 | 135 | 165 | - |
| D5 | 21 | - | 28 | 33 | 47 | 55 | - |
| D6 | - | - | - | - | - | - | - |
| D7 | - | - | - | - | - | - | - |
| D12 | 59.8 | - | 86 | 106 | 104 | 128 | - |
| D14 _{h7} | 60.2 | - | 88 | 108 | 135 | 165 | - |
| D15 | 60 | - | 87 | 107 | 103 | 127 | - |
| L1 | 60.8 | - | 90 | 110 | 140 | 170 | - |
| L2 | - | - | - | - | - | - | - |
| L3 | 10 | - | 15 | 15 | 15 | 15 | - |
| L4 | 12 | - | 17 | 17 | 17 | 17 | - |
| L5 | - | - | - | - | - | 50 | - |
| L6 | - | - | - | - | - | 5 | - |
| L7 | - | - | - | - | - | - | - |
| L9 | 24.75 | - | 36 | 44 | 55 | 67 | - |
| L10 | - | - | - | - | - | - | - |
| L11 | 63.7 | - | 86.4 | 104.8 | 120.8 | 114.8 | - |
| L24 | 40 | - | 52 | 53 | 70 | 80 | - |
| L25 | 30 | - | 35 | 35 | 50 | 55 | - |
| C1 ¹ | 46 | - | 70 | 90 | 90 | 90 | - |
| C2 ¹ | M4x0.7P | - | M5x0.8P | M6x1.0P | M6x1.0P | M6x1.0P | - |
| C3 ¹ | ≤8/≤11 | - | ≤14/≤19 | ≤24 | ≤24 | ≤24 | - |
| C4 ¹ | 28.6 | - | 37.5 | 48.2 | 48.2 | 48.2 | - |
| C5 ¹ F6 | 30 | - | 50 | 70 | 70 | 70 | - |
| C6 ¹ | 4.1 | - | 4.5 | 6 | 6 | 6 | - |
| C7 ¹ | 42 | - | 60 | 90 | 90 | 90 | - |
| C8 ¹ | 73.3 | - | 97.4 | 119.5 | 135.5 | 129.5 | - |
| C9 ¹ | 134.1 | - | 187.4 | 229.5 | 275.5 | 299.5 | - |
| C10 ¹ | 17 | - | 20 | 26 | 26 | 26 | - |
| C11 ¹ | 103.7 | - | 142.4 | 174.5 | 205.5 | 214.5 | - |
| B | 5 | - | 6 | 6 | 10 | 12 | - |
| H | 15.3 | - | 20.8 | 24.8 | 35.3 | 43.3 | - |

*1. C1~C11 are motor specific dimensions (metric std shown), size may vary according to motor flange. C1~C11是公製標準馬達連接板尺寸，請依所選用的馬達決定。
 ★ Specification subject to change without notice. 本公司有權針對以上數據規格逕行設計變更不先行告知。

PT-FH Triple Stage Dims. 三段外型尺寸圖

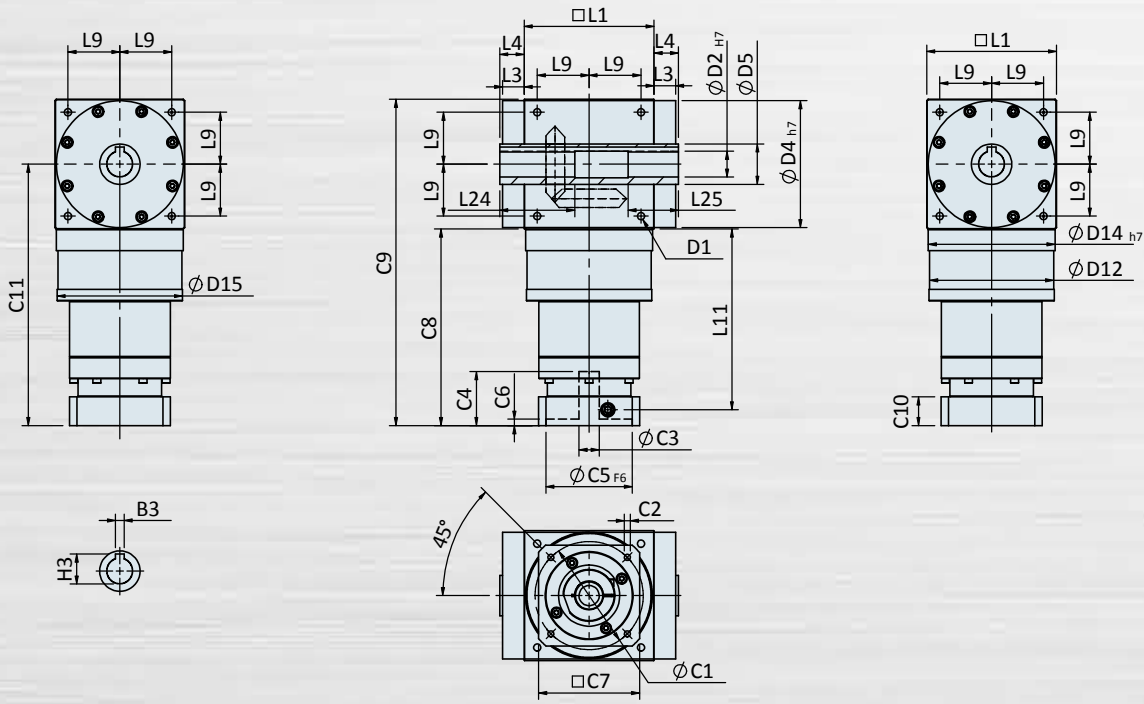

Specifications 規格

Unit: mm

| Dims. 尺寸 | PT60-FH | PT75-FH | PT90-FH | PT110-FH | PT140-FH | PT170-FH | PT210-FH |
|-------------------------------|---------|---------|---------|-------------|-------------|--------------|----------|
| D1 | - | - | - | 24-M8x1.25P | 24-M10x1.5P | 24-M12x1.75P | - |
| D2 _{H7} | - | - | - | 22 | 32 | 40 | - |
| D3 _{k6} | - | - | - | - | - | - | - |
| D4 _{H7} | - | - | - | 108 | 135 | 165 | - |
| D5 | - | - | - | 33 | 47 | 55 | - |
| D6 | - | - | - | - | - | - | - |
| D7 | - | - | - | - | - | - | - |
| D12 | - | - | - | 106 | 104 | 128 | - |
| D14 _{H7} | - | - | - | 108 | 135 | 165 | - |
| D15 | - | - | - | 107 | 103 | 127 | - |
| L1 | - | - | - | 110 | 140 | 170 | - |
| L2 | - | - | - | - | - | - | - |
| L3 | - | - | - | 15 | 15 | 15 | - |
| L4 | - | - | - | 17 | 17 | 17 | - |
| L5 | - | - | - | - | - | - | - |
| L6 | - | - | - | - | - | - | - |
| L7 | - | - | - | - | - | - | - |
| L9 | - | - | - | 44 | 55 | 67 | - |
| L10 | - | - | - | - | - | - | - |
| L11 | - | - | - | 149.8 | 165.8 | 159.8 | - |
| L24 | - | - | - | 53 | 70 | 80 | - |
| L25 | - | - | - | 35 | 50 | 55 | - |
| C1 ¹ | - | - | - | 90 | 90 | 90 | - |
| C2 ¹ | - | - | - | M6x1.0P | M6x1.0P | M6x1.0P | - |
| C3 ¹ | - | - | - | ≤24 | ≤24 | ≤24 | - |
| C4 ¹ | - | - | - | 48.2 | 48.2 | 48.2 | - |
| C5 ¹ _{F6} | - | - | - | 70 | 70 | 70 | - |
| C6 ¹ | - | - | - | 6 | 6 | 6 | - |
| C7 ¹ | - | - | - | 90 | 90 | 90 | - |
| C8 ¹ | - | - | - | 164.5 | 180.5 | 174.5 | - |
| C9 ¹ | - | - | - | 274.5 | 320.5 | 344.5 | - |
| C10 ¹ | - | - | - | 26 | 26 | 26 | - |
| C11 ¹ | - | - | - | 219.5 | 250.5 | 259.5 | - |
| B3 | - | - | - | 6 | 10 | 12 | - |
| H3 | - | - | - | 24.8 | 35.3 | 43.3 | - |

*1. C1~C11 are motor specific dimensions (metric std shown), size may vary according to motor flange. C1~C11是公製標準馬達連接板尺寸，請依所選用的馬達決定。
 ★ Specification subject to change without notice. 本公司有權針對以上數據規格逕行設計變更不先行告知。

PT-SS Single Stage Dims. 單段外型尺寸圖

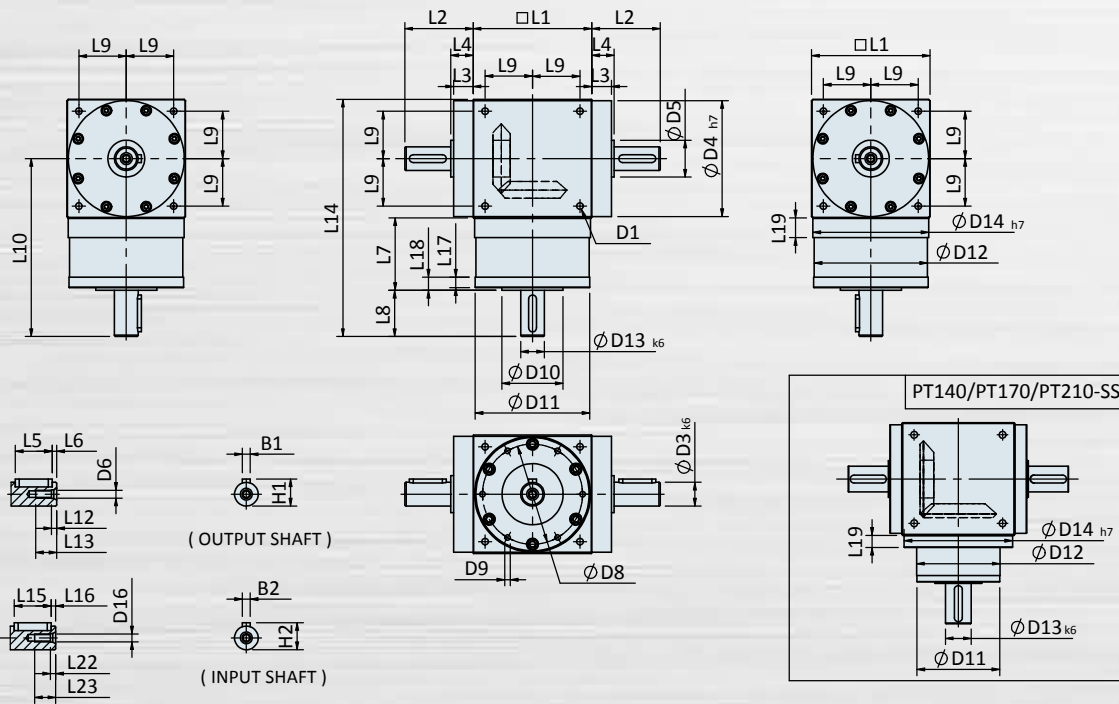

Specifications 規格

Unit: mm

| Dims. 尺寸 | PT60-SS | PT75-SS | PT90-SS | PT110-SS | PT140-SS | PT170-SS | PT210-SS |
|-------------------|------------|---------|------------|-------------|-------------|--------------|----------|
| D1 | 24-M4x0.7P | - | 24-M6x1.0P | 24-M8x1.25P | 24-M10x1.5P | 24-M12x1.75P | - |
| D3 _{k6} | 13 | - | 18 | 22 | 32 | 40 | - |
| D4 _{h7} | 60 | - | 88 | 108 | 135 | 165 | - |
| D5 | 21 | - | 28 | 33 | 47 | 55 | - |
| D6 | M4x0.7P | - | M6x1.0P | M8x1.25P | M12x1.75P | M16x2.0P | - |
| D8 | 53 | - | 76 | 95 | 92 | 114 | - |
| D9 | 4-M4x0.7P | - | 4-M5x0.8P | 6-M6x1.0P | 6-M6x1.0P | 6-M8x1.25P | - |
| D10 | 34 | - | 46 | 59 | 59 | 74.4 | - |
| D11 | 60 | - | 87 | 107 | 103 | 127 | - |
| D12 | 59.8 | - | 86 | 106 | 104 | 128 | - |
| D13 _{k6} | 13 | - | 18 | 22 | 32 | 40 | - |
| D14 _{h7} | 60.2 | - | 88 | 108 | 135 | 165 | - |
| D16 | M4x0.7P | - | M6x1.0P | M8x1.25P | M12x1.75P | M16x2.0P | - |
| L1 | 60.8 | - | 90 | 110 | 140 | 170 | - |
| L2 | 31.5 | - | 52 | 57 | 67 | 77 | - |
| L3 | 10 | - | 15 | 15 | 15 | 15 | - |
| L4 | 12 | - | 17 | 17 | 17 | 17 | - |
| L5 | 16 | - | 28 | 32 | 45 | 50 | - |
| L6 | 2 | - | 3.5 | 4 | 2.5 | 5 | - |
| L7 | 43 | - | 55 | 60 | 60 | 70 | - |
| L8 | 19.5 | - | 35 | 40 | 50 | 60 | - |
| L9 | 24.75 | - | 36 | 44 | 55 | 67 | - |
| L10 | 92.9 | - | 135 | 155 | 180 | 215 | - |
| L12 | 4 | - | 4 | 4.5 | 6 | 6 | - |
| L13 | 12 | - | 16 | 20.5 | 30 | 36 | - |
| L14 | 123.3 | - | 180 | 210 | 250 | 300 | - |
| L15 | 16 | - | 28 | 32 | 45 | 50 | - |
| L16 | 2 | - | 3.5 | 4 | 2.5 | 5 | - |
| L17 | 6 | - | 8 | 8 | 10 | 10 | - |
| L18 | 8 | - | 10 | 10 | 12 | 12 | - |
| L19 | 13 | - | 15 | 15 | 15 | 15 | - |
| L22 | 4 | - | 4 | 4.5 | 6 | 6 | - |
| L23 | 12 | - | 16 | 20.5 | 30 | 36 | - |
| B1 | 5 | - | 6 | 6 | 10 | 12 | - |
| B2 | 5 | - | 6 | 6 | 10 | 12 | - |
| H1 | 15 | - | 20.5 | 24.5 | 35 | 43 | - |
| H2 | 15 | - | 20.5 | 24.5 | 35 | 43 | - |

★ Specification subject to change without notice. 本公司有權針對以上數據規格逕行設計變更不先行告知。

PT-SSR Single Stage Dims. 單段外型尺寸圖

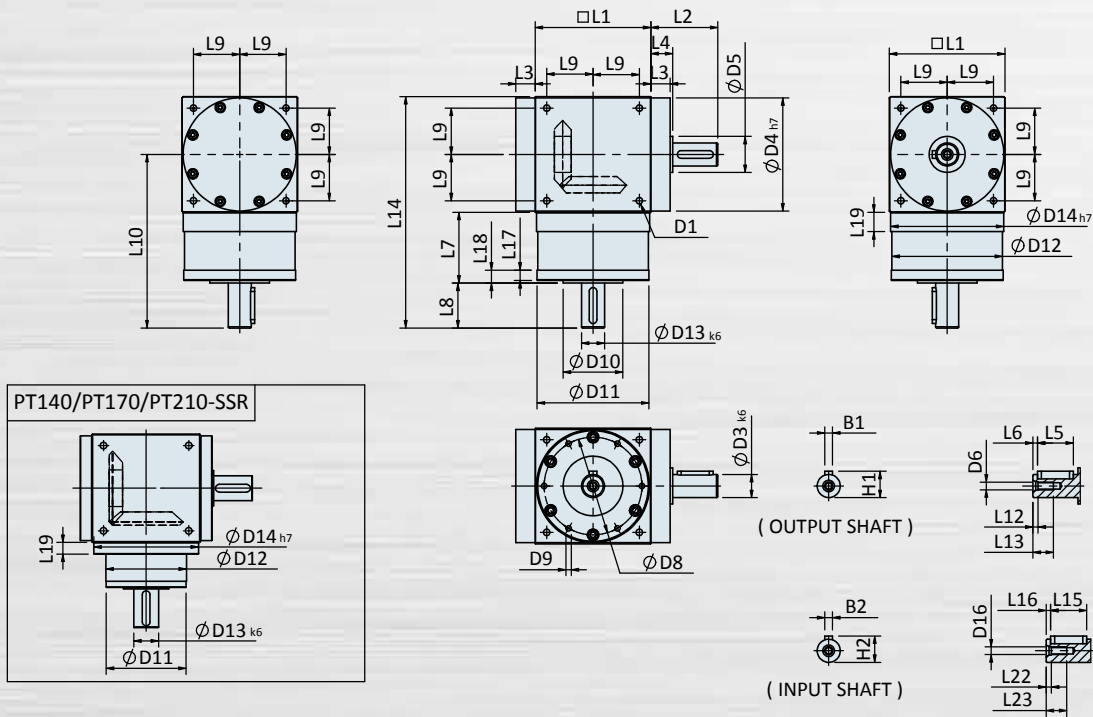

Specifications 規格

Unit: mm

| Dims. 尺寸 | PT60-SSR | PT75-SSR | PT90-SSR | PT110-SSR | PT140-SSR | PT170-SSR | PT210-SSR |
|----------|------------|----------|------------|-------------|-------------|--------------|-----------|
| D1 | 24-M4x0.7P | - | 24-M6x1.0P | 24-M8x1.25P | 24-M10x1.5P | 24-M12x1.75P | - |
| D3k6 | 13 | - | 18 | 22 | 32 | 40 | - |
| D4h7 | 60 | - | 88 | 108 | 135 | 165 | - |
| D5 | 21 | - | 28 | 33 | 47 | 55 | - |
| D6 | M4x0.7P | - | M6x1.0P | M8x1.25P | M12x1.75P | M16x2.0P | - |
| D8 | 53 | - | 76 | 95 | 92 | 114 | - |
| D9 | 4-M4x0.7P | - | 4-M5x0.8P | 6-M6x1.0P | 6-M6x1.0P | 6-M8x1.25P | - |
| D10 | 34 | - | 46 | 59 | 59 | 74.4 | - |
| D11 | 60 | - | 87 | 107 | 103 | 127 | - |
| D12 | 59.8 | - | 86 | 106 | 104 | 128 | - |
| D13k6 | 13 | - | 18 | 22 | 32 | 40 | - |
| D14h7 | 60.2 | - | 88 | 108 | 135 | 165 | - |
| D16 | M4x0.7P | - | M6x1.0P | M8x1.25P | M12x1.75P | M16x2.0P | - |
| L1 | 60.8 | - | 90 | 110 | 140 | 170 | - |
| L2 | 31.5 | - | 52 | 57 | 67 | 77 | - |
| L3 | 10 | - | 15 | 15 | 15 | 15 | - |
| L4 | 12 | - | 17 | 17 | 17 | 17 | - |
| L5 | 16 | - | 28 | 32 | 45 | 50 | - |
| L6 | 2 | - | 3.5 | 4 | 2.5 | 5 | - |
| L7 | 43 | - | 55 | 60 | 60 | 70 | - |
| L8 | 19.5 | - | 35 | 40 | 50 | 60 | - |
| L9 | 24.75 | - | 36 | 44 | 55 | 67 | - |
| L10 | 92.9 | - | 135 | 155 | 180 | 215 | - |
| L12 | 4 | - | 4 | 4.5 | 6 | 6 | - |
| L13 | 12 | - | 16 | 20.5 | 30 | 36 | - |
| L14 | 123.3 | - | 180 | 210 | 250 | 300 | - |
| L15 | 16 | - | 28 | 32 | 45 | 50 | - |
| L16 | 2 | - | 3.5 | 4 | 2.5 | 5 | - |
| L17 | 6 | - | 8 | 8 | 10 | 10 | - |
| L18 | 8 | - | 10 | 10 | 12 | 12 | - |
| L19 | 13 | - | 15 | 15 | 15 | 15 | - |
| L22 | 4 | - | 4 | 4.5 | 6 | 6 | - |
| L23 | 12 | - | 16 | 20.5 | 30 | 36 | - |
| B1 | 5 | - | 6 | 6 | 10 | 12 | - |
| B2 | 5 | - | 6 | 6 | 10 | 12 | - |
| H1 | 15 | - | 20.5 | 24.5 | 35 | 43 | - |
| H2 | 15 | - | 20.5 | 24.5 | 35 | 43 | - |

★ Specification subject to change without notice. 本公司有權針對以上數據規格逕行設計變更不先行告知。

PT-SSL Single Stage Dims. 單段外型尺寸圖

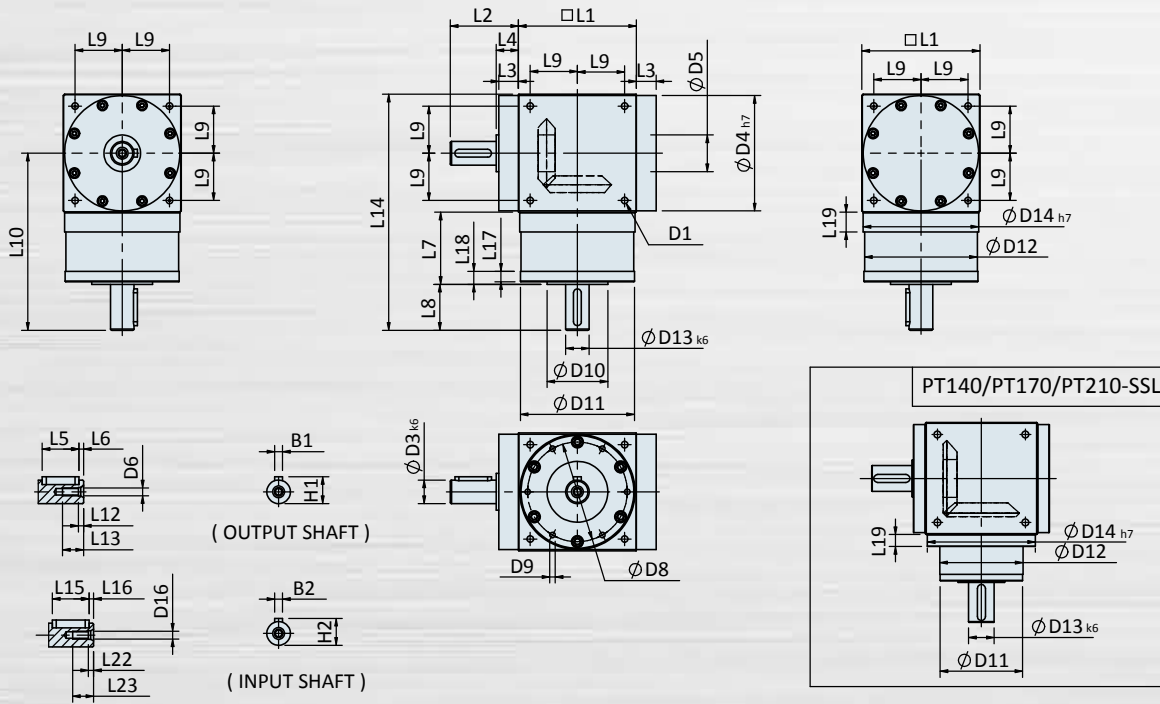

Specifications 規格

Unit: mm

| Dims. 尺寸 | PT60-SSL | PT75-SSL | PT90-SSL | PT110-SSL | PT140-SSL | PT170-SSL | PT210-SSL |
|----------|------------|----------|------------|-------------|-------------|--------------|-----------|
| D1 | 24-M4x0.7P | - | 24-M6x1.0P | 24-M8x1.25P | 24-M10x1.5P | 24-M12x1.75P | - |
| D3k6 | 13 | - | 18 | 22 | 32 | 40 | - |
| D4h7 | 60 | - | 88 | 108 | 135 | 165 | - |
| D5 | 21 | - | 28 | 33 | 47 | 55 | - |
| D6 | M4x0.7P | - | M6x1.0P | M8x1.25P | M12x1.75P | M16x2.0P | - |
| D8 | 53 | - | 76 | 95 | 92 | 114 | - |
| D9 | 4-M4x0.7P | - | 4-M5x0.8P | 6-M6x1.0P | 6-M6x1.0P | 6-M8x1.25P | - |
| D10 | 34 | - | 46 | 59 | 59 | 74.4 | - |
| D11 | 60 | - | 87 | 107 | 103 | 127 | - |
| D12 | 59.8 | - | 86 | 106 | 104 | 128 | - |
| D13k6 | 13 | - | 18 | 22 | 32 | 40 | - |
| D14h7 | 60.2 | - | 88 | 108 | 135 | 165 | - |
| D16 | M4x0.7P | - | M6x1.0P | M8x1.25P | M12x1.75P | M16x2.0P | - |
| L1 | 60.8 | - | 90 | 110 | 140 | 170 | - |
| L2 | 31.5 | - | 52 | 57 | 67 | 77 | - |
| L3 | 10 | - | 15 | 15 | 15 | 15 | - |
| L4 | 12 | - | 17 | 17 | 17 | 17 | - |
| L5 | 16 | - | 28 | 32 | 45 | 50 | - |
| L6 | 2 | - | 3.5 | 4 | 2.5 | 5 | - |
| L7 | 43 | - | 55 | 60 | 60 | 70 | - |
| L8 | 19.5 | - | 35 | 40 | 50 | 60 | - |
| L9 | 24.75 | - | 36 | 44 | 55 | 67 | - |
| L10 | 92.9 | - | 135 | 155 | 180 | 215 | - |
| L12 | 4 | - | 4 | 4.5 | 6 | 6 | - |
| L13 | 12 | - | 16 | 20.5 | 30 | 36 | - |
| L14 | 123.3 | - | 180 | 210 | 250 | 300 | - |
| L15 | 16 | - | 28 | 32 | 45 | 50 | - |
| L16 | 2 | - | 3.5 | 4 | 2.5 | 5 | - |
| L17 | 6 | - | 8 | 8 | 10 | 10 | - |
| L18 | 8 | - | 10 | 10 | 12 | 12 | - |
| L19 | 13 | - | 15 | 15 | 15 | 15 | - |
| L22 | 4 | - | 4 | 4.5 | 6 | 6 | - |
| L23 | 12 | - | 16 | 20.5 | 30 | 36 | - |
| B1 | 5 | - | 6 | 6 | 10 | 12 | - |
| B2 | 5 | - | 6 | 6 | 10 | 12 | - |
| H1 | 15 | - | 20.5 | 24.5 | 35 | 43 | - |
| H2 | 15 | - | 20.5 | 24.5 | 35 | 43 | - |

★ Specification subject to change without notice. 本公司有權針對以上數據規格逕行設計變更不先行告知。

PT-SH Single Stage Dims. 單段外型尺寸圖

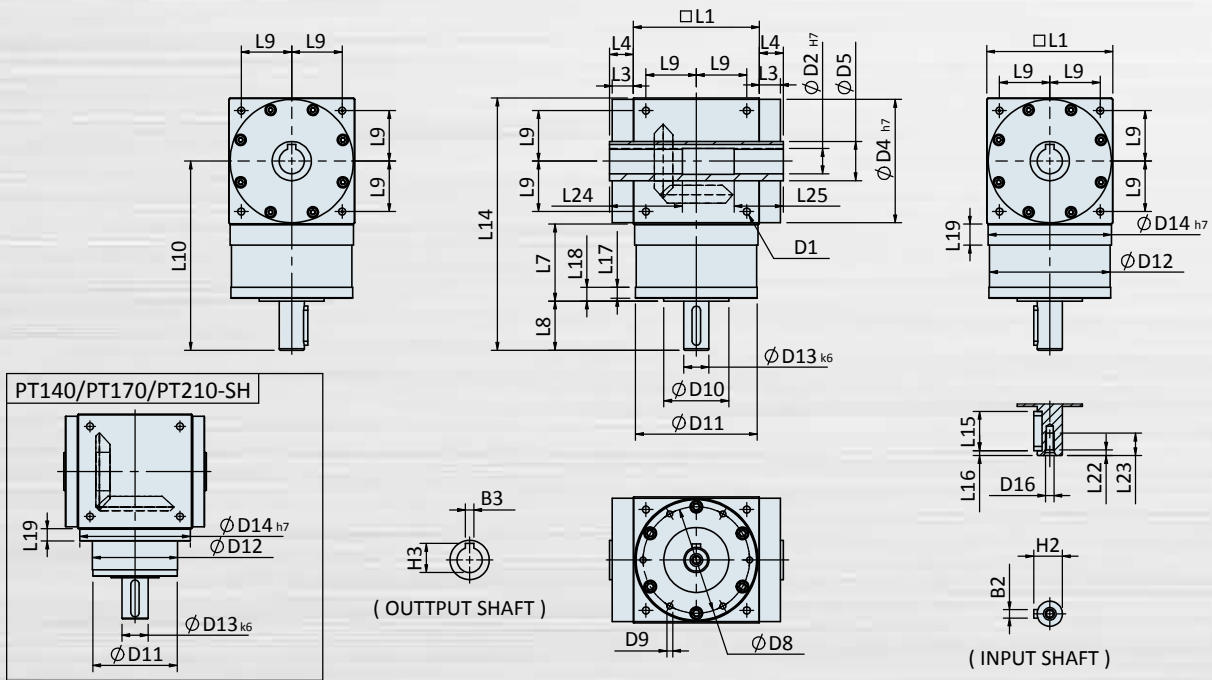

Specifications 規格

Unit: mm

| Dims. 尺寸 | PT60-SH | PT75-SH | PT90-SH | PT110-SH | PT140-SH | PT170-SH | PT210-SH |
|----------|------------|---------|------------|-------------|-------------|--------------|----------|
| D1 | 24-M4x0.7P | - | 24-M6x1.0P | 24-M8x1.25P | 24-M10x1.5P | 24-M12x1.75P | - |
| D2h7 | 13 | - | 18 | 22 | 32 | 40 | - |
| D4h7 | 60 | - | 88 | 108 | 135 | 165 | - |
| D5 | 21 | - | 28 | 33 | 47 | 55 | - |
| D6 | - | - | - | - | - | - | - |
| D8 | 53 | - | 76 | 95 | 92 | 114 | - |
| D9 | 4-M4x0.7P | - | 4-M5x0.8P | 6-M6x1.0P | 6-M6x1.0P | 6-M8x1.25P | - |
| D10 | 34 | - | 46 | 59 | 59 | 74.4 | - |
| D11 | 60 | - | 87 | 107 | 103 | 127 | - |
| D12 | 59.8 | - | 86 | 106 | 104 | 128 | - |
| D13k6 | 13 | - | 18 | 22 | 32 | 40 | - |
| D14h7 | 60.2 | - | 88 | 108 | 135 | 165 | - |
| D16 | M4x0.7P | - | M6x1.0P | M8x1.25P | M12x1.75P | M16x2.0P | - |
| L1 | 60.8 | - | 90 | 110 | 140 | 170 | - |
| L2 | - | - | - | - | - | - | - |
| L3 | 10 | - | 15 | 15 | 15 | 15 | - |
| L4 | 12 | - | 17 | 17 | 17 | 17 | - |
| L5 | - | - | - | - | - | - | - |
| L6 | - | - | - | - | - | - | - |
| L7 | 43 | - | 55 | 60 | 60 | 70 | - |
| L8 | 19.5 | - | 35 | 40 | 50 | 60 | - |
| L9 | 24.75 | - | 36 | 44 | 55 | 67 | - |
| L10 | 92.9 | - | 135 | 155 | 180 | 215 | - |
| L14 | 123.3 | - | 180 | 210 | 250 | 300 | - |
| L15 | 16 | - | 28 | 32 | 45 | 50 | - |
| L16 | 2 | - | 3.5 | 4 | 2.5 | 5 | - |
| L17 | 6 | - | 8 | 8 | 10 | 10 | - |
| L18 | 8 | - | 10 | 10 | 12 | 12 | - |
| L19 | 13 | - | 15 | 15 | 15 | 15 | - |
| L22 | 4 | - | 4 | 4.5 | 6 | 6 | - |
| L23 | 12 | - | 16 | 20.5 | 30 | 36 | - |
| L24 | 40 | - | 52 | 53 | 70 | 80 | - |
| L25 | 30 | - | 35 | 35 | 50 | 55 | - |
| B2 | 5 | - | 6 | 6 | 10 | 12 | - |
| B3 | 5 | - | 6 | 6 | 10 | 12 | - |
| H2 | 15 | - | 20.5 | 24.5 | 35 | 43 | - |
| H3 | 15.3 | - | 20.8 | 24.8 | 35.3 | 43.3 | - |

★ Specification subject to change without notice. 本公司有權針對以上數據規格逕行設計變更不先行告知。

PT Flange Input Specs. Table 法蘭型性能規格共表

| Specifications 規格 | | Stage 節數 | Ratio 減速比 | PT60 (FS/FSL/FSR/FH) | PT75 (FS/FSL/FSR/FH) | PT90 (FS/FSL/FSR/FH) | PT110 (FS/FSL/FSR/FH) | PT140 (FS/FSL/FSR/FH) | PT170 (FS/FSL/FSR/FH) | PT210 (FS/FSL/FSR/FH) | |
|---|------------|--|---|----------------------|----------------------|-----------------------|-----------------------|-----------------------|-----------------------|-----------------------|------|
| Nominal Output Torque 額定輸出力矩T _{2N} | N · m | 1 | 1 | 25 | 45 | 78 | 150 | 360 | 585 | 1300 | |
| | | | 1.5 | 25 | 45 | 78 | 150 | 360 | 585 | 1300 | |
| | | | 2 | 24 | 42 | 68 | 150 | 330 | 544 | 1220 | |
| | | | 3 | 18 | 33 | 54 | 120 | 270 | 450 | 1020 | |
| | | | 4 | 13 | 28 | 48 | 100 | 224 | 376 | 860 | |
| | | 2 | 5 | 12 | 25 | 40 | 85 | 196 | 320 | 740 | |
| | | | 7 | 13 | 13 | 40 | 100 | 100 | 100 | 210 | |
| | | | 9 | - | 33 | 54 | 120 | 210 | 210 | 430 | |
| | | | 10 | 24 | 42 | 68 | 150 | 208 | 208 | 460 | |
| | | | 15 | 18 | 33 | 54 | 120 | 270 | 312 | 645 | |
| | | | 20 | 13 | 28 | 48 | 100 | 224 | 376 | 860 | |
| | | | 25 | 12 | 25 | 40 | 85 | 196 | 320 | 740 | |
| | | | 35 | 12 | 25 | 40 | 85 | 196 | 320 | 740 | |
| | | | 50 | 12 | 25 | 40 | 85 | 196 | 320 | 740 | |
| | | | 3 | 75 | - | - | - | 120 | 270 | 312 | 645 |
| | | 100 | | - | - | - | 100 | 224 | 376 | 860 | |
| | | 125 | | - | - | - | 85 | 196 | 320 | 740 | |
| | | 150 | | - | - | - | 120 | 270 | 312 | 645 | |
| | | 200 | | - | - | - | 100 | 224 | 376 | 860 | |
| | | 250 | | - | - | - | 85 | 196 | 320 | 740 | |
| | | 350 | | - | - | - | 85 | 196 | 320 | 740 | |
| 500 | - | - | - | 85 | 196 | 320 | 740 | | | | |
| Emergency Stop Torque 急停力矩T _{2NOT} | N · m | 2.0 Times of Nominal Output Torque 2.0倍額定輸出力矩 (* Max. Output Torque 最大輸出力矩T _{2B} =1.5 Times of Nominal Output Torque 1.5倍額定輸出力矩) | | | | | | | | | |
| Nominal Input Speed 額定輸入轉速n _{1N} | rpm | 1 | 1 | 2500 | 2000 | 1700 | 1400 | 1100 | 1000 | 800 | |
| | | | 1.5, 2 | 3000 | 2500 | 2000 | 1600 | 1400 | 1300 | 1050 | |
| | | | 3, 4, 5 | 3500 | 3000 | 2500 | 2100 | 2000 | 1800 | 160 | |
| | | 2 | 7-50 | 5000 | 5000 | 4000 | 4000 | 4000 | 3500 | 3000 | |
| Max. Input Speed 額定輸入轉速n _{1max} | rpm | 1 | 1-5 | 7500 | 6500 | 5500 | 4500 | 3500 | 3000 | 2200 | |
| | | 2 | 7-50 | 8000 | 8000 | 6000 | 6000 | 6000 | 6000 | 4800 | |
| | | 3 | 75-500 | - | - | - | 8000 | 8000 | 8000 | 6000 | |
| Standard Backlash P2 標準背隙 | arcmin | 1 | 1-5 | ≤6 | ≤6 | ≤6 | ≤6 | ≤6 | ≤6 | ≤6 | |
| | | 2 | 7-50 | ≤8 | ≤8 | ≤8 | ≤8 | ≤8 | ≤8 | ≤8 | |
| | | 3 | 75-500 | - | - | - | ≤10 | ≤10 | ≤10 | ≤10 | |
| Max. Radial Load 輸出軸容許徑向力F _{2rB} ¹ | N | 1,2,3 | 1-500 | 900 | 1100 | 1700 | 2700 | 4800 | 6600 | 11500 | |
| Max. Axial Load 輸出軸容許軸向力F _{2aB} ¹ | N | 1,2,3 | 1-500 | 450 | 550 | 850 | 1350 | 2400 | 3300 | 5750 | |
| Operating Temp. 使用溫度 | °C | 1,2,3 | -10°C ~ +90°C | | | | | | | | |
| Service Life 使用壽命 | hrs | 1,2,3 | 20,000 (10,000 Continuous Operation 連續運轉) | | | | | | | | |
| Efficiency 效率 | % | 1 | ≥ 98% | | | | | | | | |
| | | 2,3 | ≥ 94% | | | | | | | | |
| Weight 重量 | FS/FSL/FSR | kg | 1 | 1-5 | 2.8 | 4.6 | 7.5 | 12.8 | 21.8 | 38.3 | 72.6 |
| | | | 2 | 7-50 | 3.2 | 5.2 | 8.5 | 15.3 | 25.1 | 40.7 | 77.3 |
| | | | 3 | 75-500 | - | - | - | 16.1 | 25.9 | 42.0 | 79.2 |
| | FH | kg | 1 | 1-5 | 2.6 | 4.3 | 7.1 | 12.1 | 20.0 | 34.9 | 66.1 |
| | | | 2 | 7-50 | 3.1 | 4.9 | 8.1 | 14.6 | 23.5 | 37.3 | 70.8 |
| | | | 3 | 75-500 | - | - | - | 15.4 | 24.3 | 38.5 | 72.4 |
| Mounting Position 安裝方向 | - | 1,2,3 | Any Direction 任意方向 | | | | | | | | |
| Noise Level 噪音值 ² | dBA/1m | 1,2,3 | 1-500 | 68 | 70 | 74 | 75 | 76 | 77 | 79 | |
| Protection Class 防護等級 | - | 1,2,3 | IP65 | | | | | | | | |
| Lubrication 潤滑 | - | 1,2,3 | Synthetic Lubricant 全合成潤滑油脂 | | | | | | | | |
| Inertia 減速機轉動慣量 (J1) | | | | | | | | | | | |
| Stage 節數 | Ratio 減速比 | unit 單位 | PT60 (FS/FSL/FSR/FH) | PT75 (FS/FSL/FSR/FH) | PT90 (FS/FSL/FSR/FH) | PT110 (FS/FSL/FSR/FH) | PT140 (FS/FSL/FSR/FH) | PT170 (FS/FSL/FSR/FH) | PT210 (FS/FSL/FSR/FH) | | |
| 1 | 1 | Kg · cm ² | 0.51 | 1.35 | 3.21 | 7.82 | 25.1 | 61.5 | 198.9 | | |
| | 1.5 | | 0.46 | 1.18 | 2.9 | 6.85 | 20.3 | 51.2 | 158.2 | | |
| | 2 | | 0.44 | 1.15 | 2.75 | 6.52 | 18.7 | 47.3 | 142.5 | | |
| | 3-5 | | 0.43 | 1.11 | 2.71 | 6.21 | 18.1 | 45.2 | 136.5 | | |
| 2 | 7-50 | 0.04 | 0.07 | 0.32 | 1.0 | 1.6 | 3.1 | 9.8 | | | |
| 3 | 75-500 | - | - | - | 0.23 | 0.26 | 0.75 | 1.0 | | | |

1. Applied to the output shaft center at 400 rpm. 輸出轉速400 rpm時，作用於輸出軸中心位置。

2. Measured at 1500 rpm with no load. 1500 rpm空載量測。

※ The above figures/specifications are subject to change without prior notice. 本公司有權對以上數據規格逕行設計變更不先行告知。

PT Solid Shaft Input Specs. Table 軸型性能規格共表

| Specification 規格 | | Stage 節數 | Ratio 減速比 | PT60 (SS/SSL/SSR/SH) | P75 (SS/SSL/SSR/SH) | PT90 (SS/SSL/SSR/SH) | PT110 (SS/SSL/SSR/SH) | PT140 (SS/SSL/SSR/SH) | PT170 (SS/SSL/SSR/SH) | PT210 (SS/SSL/SSR/SH) | |
|--|----------|--|-----------|-----------------------------|---------------------|----------------------|-----------------------|-----------------------|-----------------------|-----------------------|------|
| Nominal Output Torque 額定輸出力矩T _{2N} | N · m | 1 | 1 | 25 | 45 | 78 | 150 | 360 | 585 | 1300 | |
| | | | 1.5 | 25 | 45 | 78 | 150 | 360 | 585 | 1300 | |
| | | | 2 | 24 | 42 | 68 | 150 | 330 | 544 | 1220 | |
| | | | 3 | 18 | 33 | 54 | 120 | 270 | 450 | 1020 | |
| | | | 4 | 13 | 28 | 48 | 100 | 224 | 376 | 860 | |
| 5 | 12 | 25 | 40 | 85 | 196 | 320 | 740 | | | | |
| Emergency Stop Torque 急停力矩T _{2NOT} | N · m | 2.0 Times of Nominal Output Torque 2.0倍額定輸出力矩 (* Max. Output Torque 最大輸出力矩T _{2B} =1.5 Times of Nominal Output Torque 1.5倍額定輸出力矩) | | | | | | | | | |
| Nominal Input Speed 額定輸入轉速 Ω_{1N} | rpm | 1 | 1 | 2500 | 2000 | 1700 | 1400 | 1100 | 1000 | 800 | |
| | | 1 | 1.5, 2 | 3000 | 2500 | 2000 | 1600 | 1400 | 1300 | 1050 | |
| | | 1 | 3, 4, 5 | 3500 | 3000 | 2500 | 2100 | 2000 | 1800 | 1600 | |
| Max. Input Speed 最大輸入轉速 Ω_{1max} | rpm | 1 | 1-5 | 7500 | 6500 | 5500 | 4500 | 3500 | 3000 | 2200 | |
| Standard Backlash P2 標準背隙 | arcmin | 1 | 1-5 | ≤6 | ≤6 | ≤6 | ≤6 | ≤6 | ≤6 | ≤6 | |
| Max. Radial Load on Output Shaft 輸出軸容許徑向力F _{2rB} ¹ | N | 1 | 1-5 | 900 | 1100 | 1700 | 2700 | 4800 | 6600 | 11500 | |
| Max. Axial Load on Output Shaft 輸出軸容許軸向力F _{2aB} ¹ | N | 1 | 1-5 | 450 | 550 | 850 | 1350 | 2400 | 3300 | 5750 | |
| Max. Radial Load on Input Shaft 輸入軸容許徑向力F _{1rB} ² | N | 1 | 1-5 | 700 | 950 | 1450 | 2100 | 2700 | 3800 | 7800 | |
| Max. Axial Load on Input Shaft 輸入軸容許軸向力F _{1aB} ² | N | 1 | 1-5 | 350 | 425 | 725 | 1050 | 1350 | 1900 | 3900 | |
| Operating Temp. 使用溫度 | °C | -10°C ~ +90°C | | | | | | | | | |
| Service Life 使用壽命 | hrs | 20,000 (10,000 Continuous Operation 連續運轉) | | | | | | | | | |
| Efficiency 效率 | % | ≥98% | | | | | | | | | |
| Weight 重量 | SS | kg | 1 | 1-5 | 2.6 | 4.4 | 7.2 | 12.2 | 20.8 | 36.5 | 69.2 |
| | SSL | kg | 1 | 1-5 | 2.5 | 4.3 | 7.1 | 12.1 | 20.5 | 35.9 | 68.1 |
| | SSR | kg | 1 | 1-5 | 2.5 | 4.3 | 7.1 | 12.1 | 20.5 | 35.9 | 68.1 |
| | SH | kg | 1 | 1-5 | 2.4 | 4.1 | 6.8 | 11.6 | 19.1 | 33.3 | 63.0 |
| Mounting Position 安裝方向 | - | 1 | 1-5 | Any Direction 任意方向 | | | | | | | |
| Noise Level 噪音值 ² | dB(A)/1m | 1 | 1-5 | 66 | 68 | 72 | 74 | 75 | 76 | 78 | |
| Protection Class 防護等級 | - | 1 | 1-5 | IP65 | | | | | | | |
| Lubrication 潤滑 | - | 1 | 1-5 | Synthetic Lubricant 全合成潤滑油脂 | | | | | | | |

Inertia 減速機轉動慣量 (J1)

| Sage 節數 | Ratio 減速比 | unit 單位 | PT60 (SS/SSL/SSR/SH) | P75 (SS/SSL/SSR/SH) | PT90 (SS/SSL/SSR/SH) | PT110 (SS/SSL/SSR/SH) | PT140 (SS/SSL/SSR/SH) | PT170 (SS/SSL/SSR/SH) | PT210 (SS/SSL/SSR/SH) |
|---------|-----------|----------------------|----------------------|---------------------|----------------------|-----------------------|-----------------------|-----------------------|-----------------------|
| 1 | 1 | Kg · cm ² | 0.51 | 1.35 | 3.21 | 7.82 | 25.1 | 61.5 | 198.9 |
| | 1.5 | | 0.46 | 1.18 | 2.9 | 6.85 | 20.3 | 51.2 | 158.2 |
| | 2 | | 0.44 | 1.15 | 2.75 | 6.52 | 18.7 | 47.3 | 142.5 |
| | 3-5 | | 0.43 | 1.11 | 2.71 | 6.21 | 18.1 | 45.2 | 136.5 |

* 1. Applied to the output shaft center at 400 rpm. 輸出轉速400 rpm時，作用於輸出軸中心位置。

* 2. Measured at 1500 rpm with no load. 1500 rpm空載量測。

※ The above figures/specifications are subject to change without prior notice. 本公司有權對以上數據規格逕行設計變更不先行告知。

Products due to human error, natural disasters or other factors lead to poor or damaged, will not be covered under warranty.
產品因人為原因或天災等因素導致不良或損壞，不在保固範圍內。

AGENT

世協電機股份有限公司

599, Sec 1, Hemu Rd., Shengang, Taichung 42953, Taiwan

TEL : +886-4-2561-0011

FAX : +886-4-2562-7766

Skype phone : sesame_motor

info@sesamemotor.com.tw

www.sesamemotor.com

