

## PRECISION INDEX TABLE

Model: HPI-300, 450, 600, 800, 1000, 1200

- The "HOMGE" PRECISION INDEXING TABLES are constructed with an AIR CYLINDER between the mating surfaces. This system ensures reduces friction when heavy loads are applied to the table. High accuracy and repeatability are achieved.
- HEAVY DUTY CONSTRUCTION is built of (FCD 55) Ductile Iron suitable for heavy cutting.



Curved Coupling Gear is made of **HIGH GRADE BEARING STEEL** which provides rigidity and super high precision.

### STANDARD ACCESSORIES

- AIR COUPLER for connection to air supply
- 30cm RUBBER PIPE
- 4 pcs of CLAMPING BLOCKS

### PERMISSIBLE CUTTING FORCE

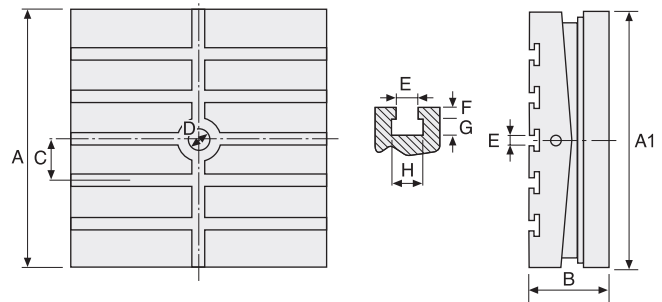
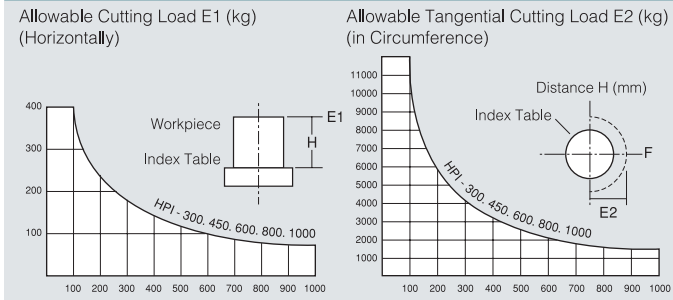

### SPECIFICATIONS

Unit: mm/inch

Model	HPI-300	HPI-450	HPI-600	HPI-800	HPI-1000	HPI-1200
1 LXW	300x300 (12"x12")	450x450 (18"x18")	600x600 (24"x24")	800x800 (32"x32")	1000x1000 (40"x40")	1200x1200 (47"x47")
2 Height	130 (5 1/8")	160 (6 1/16")	200 (7 7/8")	280 (11")	300 (12")	300 (12")
3 Spindle hole	25 (1")	30 (1 1/16")	40 (1 1/2")	65 (2 5/16")	60 (2 3/8")	60 (2 3/8")
4 T-Slot	14 (9/16")	18 (1 1/16")	20 (3/4")	22 (7/8")	22 (7/8")	22 (7/8")
5 Driving	Air Pressure 5~8kgs/cm <sup>2</sup>					
	Manual					
6 Maximum load weight vertically in theory	1200 (2645 lb)	2400 (5921 lb)	3400 (7496 lb)	4500 (9920 lb)	6000 (13225 lb)	6000 (13225 lb)
7 Allowable load weight (kg)	500 (1102 lb)	1000 (2205 lb)	2000 (4409 lb)	3000 (6614 lb)	5000 (11021 lb)	5000 (11021 lb)
8 Number of division	Divisors of 24 2, 3, 4, 6, 8, 12	Divisors of 72 (2,3,4,6,8,12,18,24,36,72) and divisions by integers of 5° angles, custom-made orders for special dividing integers.				
9 Table rotation	clockwise and anticlockwise					
10 Division	15°	5°				
11 Weight (kg)	90	200	460	900	1200	1800

### SPECIFICATIONS (Material: FCD 55 Ductile Iron)

Unit: mm/inch

Model	HPI-300	HPI-450	HPI-600	HPI-800	HPI-1000	HPI-1200
<b>Unit</b>	mm inch	mm inch	mm inch	mm inch	mm inch	mm inch
<b>A</b>	300 12	450 18	600 24	800 32	1000 40	1200 47
<b>A1</b>	300 12	450 18	600 24	800 32	1000 40	1000 40
<b>B</b>	130 5 1/8	160 6 1/16	200 7 7/8	280 11	300 12	300 12
<b>C</b>	100 4	100 4	100 4	100 4	125 5	150 6
<b>D</b>	25 1	30 1 1/16	40 1 1/2	65 2 5/16	60 2 3/8	90 3 1/2
<b>E</b>	14 9/16	18 1 1/16	20 3/4	22 7/8	22 7/8	22 7/8
<b>F</b>	14 9/16	16 5/8	20 3/4	23 1 5/16	23 1 5/16	23 1 5/16
<b>G</b>	12 1 5/32	12 1 5/32	14 9/16	15 1 9/32	15 1 9/32	15 1 9/32
<b>H</b>	25 1	30 1 13/16	34 1 3/8	38 1 1/2	38 1 1/2	38 1 1/2