

高速頂針 (螺帽型) HIGH-SPEED LIVE CENTER (WITH NUT)

RPM: 1500 - 5000 MT/MK. 3, 4, 5, 6



www.lihsun.com

NCH 型 LIVE CENTER



A-TYPE



B-TYPE

迷宮式迴轉頂針無油防水結構
專利號碼 M553237

MAZE TYPE, WATERPROOF DESIGNED
WITHOUT SEAL, PAT. NO. M553237

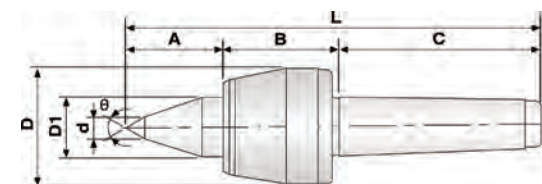
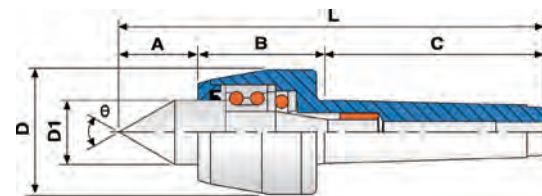
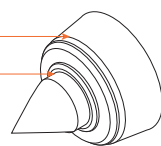

特殊規格 SPECIAL ORDER

錫鋼 WITH CARBIDE TIPPED

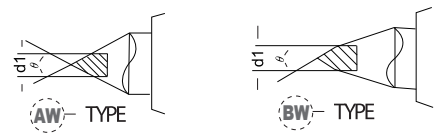

NCH-T 型 LIVE CENTER



AT-TYPE



BT-TYPE

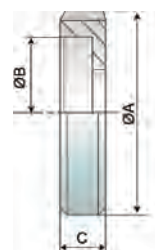
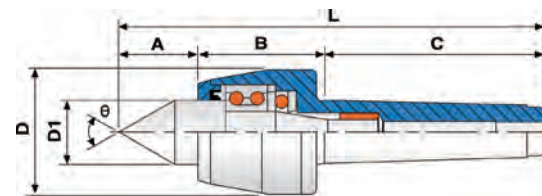

| MORES TAPER MT / MK | DIMENSIONS (mm) | | |
|--------------------------|-----------------|-----------|----|
| | A | B | C |
| NCH-MT.4AT NCH-MT.4BT | 69 | M60 x 1.5 | 20 |
| NCH-MT.5AT NCH-MT.5BT | 92 | M80 x 1.5 | 25 |

NCH 型 LIVE CENTER

1. 前端使用雙列滾珠軸承及止推軸承，滾針軸承之組合。
 2. 適用於CNC車床，具中負荷使用與防水性。
 3. 車床尾座調整壓力建議5~8公斤。
- ※ NCH-B(T)型；適合小工作物之加工切削。

1. Center shaft is made of alloy steel and hardened through vacuum heat treatment to provide higher rigidity HRC60°±1°
 2. Center is fitted with dual ball bearing, thrust bearing and needle roller bearing assembly, the waterproof is maze type.
 3. The tailstock pressure of lathe adjusts to five to eight kilograms. (for reference)
- ※ Applicable to high speed lathes and CNC lathes with heavy loads.

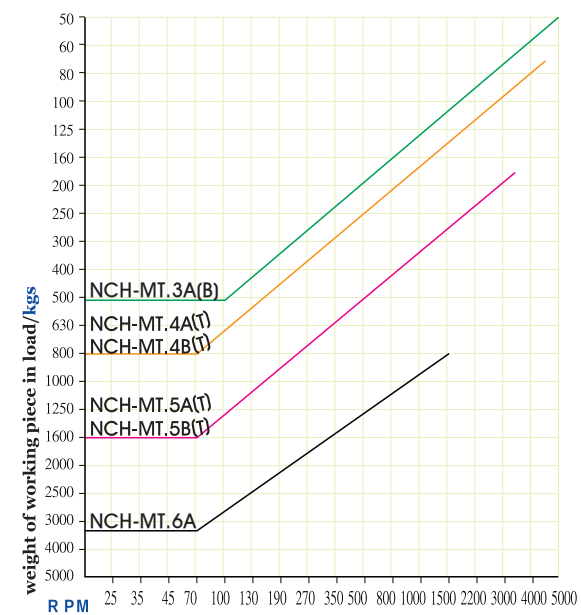

單位/Unit:mm

| ORDER NO. | MORES TAPER MT/MK | A | B | C | D | D1 | d | L | d1 | Co精度 Accuracy | Max R.P.M | θ | G.W. WEIGHT kgs | 包裝尺寸 L x W x H |
|-----------|----------------------|----|-----|-----|-----|----|----|-----|----|------------------|--------------|-----|--------------------|-------------------|
| 08030003 | NCH-MT.3A | 39 | 55 | 86 | 53 | 30 | - | 180 | 12 | 0.003 | 5000R.P.M | 60° | 1.30 kgs | 240 x 80 x 65 |
| 08030004 | NCH-MT.4A | 42 | 62 | 108 | 63 | 32 | - | 208 | 12 | 0.003 | 4500R.P.M | 60° | 2.08 kgs | 263 x 100 x 90 |
| 08030005 | NCH-MT.5A | 49 | 71 | 136 | 83 | 40 | - | 256 | 18 | 0.003 | 3500R.P.M | 60° | 4.40 kgs | 320 x 118 x 110 |
| 08030006 | NCH-MT.6A | 80 | 110 | 189 | 128 | 70 | - | 379 | - | 0.008 | 1500R.P.M | 60° | 16.5 kgs | 425 x 185 x 180 |
| 08030013 | NCH-MT.3B | 45 | 55 | 86 | 53 | 30 | 10 | 186 | 12 | 0.003 | 5000R.P.M | 60° | 1.34 kgs | 240 x 80 x 65 |
| 08030014 | NCH-MT.4B | 52 | 62 | 108 | 63 | 32 | 12 | 218 | 12 | 0.003 | 4500R.P.M | 60° | 2.12 kgs | 263 x 100 x 90 |
| 08030015 | NCH-MT.5B | 65 | 71 | 136 | 83 | 40 | 14 | 266 | 18 | 0.003 | 3500R.P.M | 60° | 4.42 kgs | 320 x 118 x 110 |
| 08020044 | NCH-MT.4AT | 42 | 62 | 108 | 60 | 32 | - | 208 | 12 | 0.003 | 4500R.P.M | 60° | 2.42 kgs | 263 x 100 x 90 |
| 08020045 | NCH-MT.5AT | 49 | 71 | 136 | 80 | 40 | - | 256 | 18 | 0.003 | 3500R.P.M | 60° | 5.02 kgs | 320 x 118 x 110 |
| 08020054 | NCH-MT.4BT | 52 | 62 | 108 | 60 | 32 | 12 | 218 | 12 | 0.003 | 4500R.P.M | 60° | 2.46 kgs | 263 x 100 x 90 |
| 08020055 | NCH-MT.5BT | 65 | 71 | 136 | 80 | 40 | 14 | 266 | 18 | 0.003 | 3500R.P.M | 60° | 5.04 kgs | 320 x 118 x 110 |