

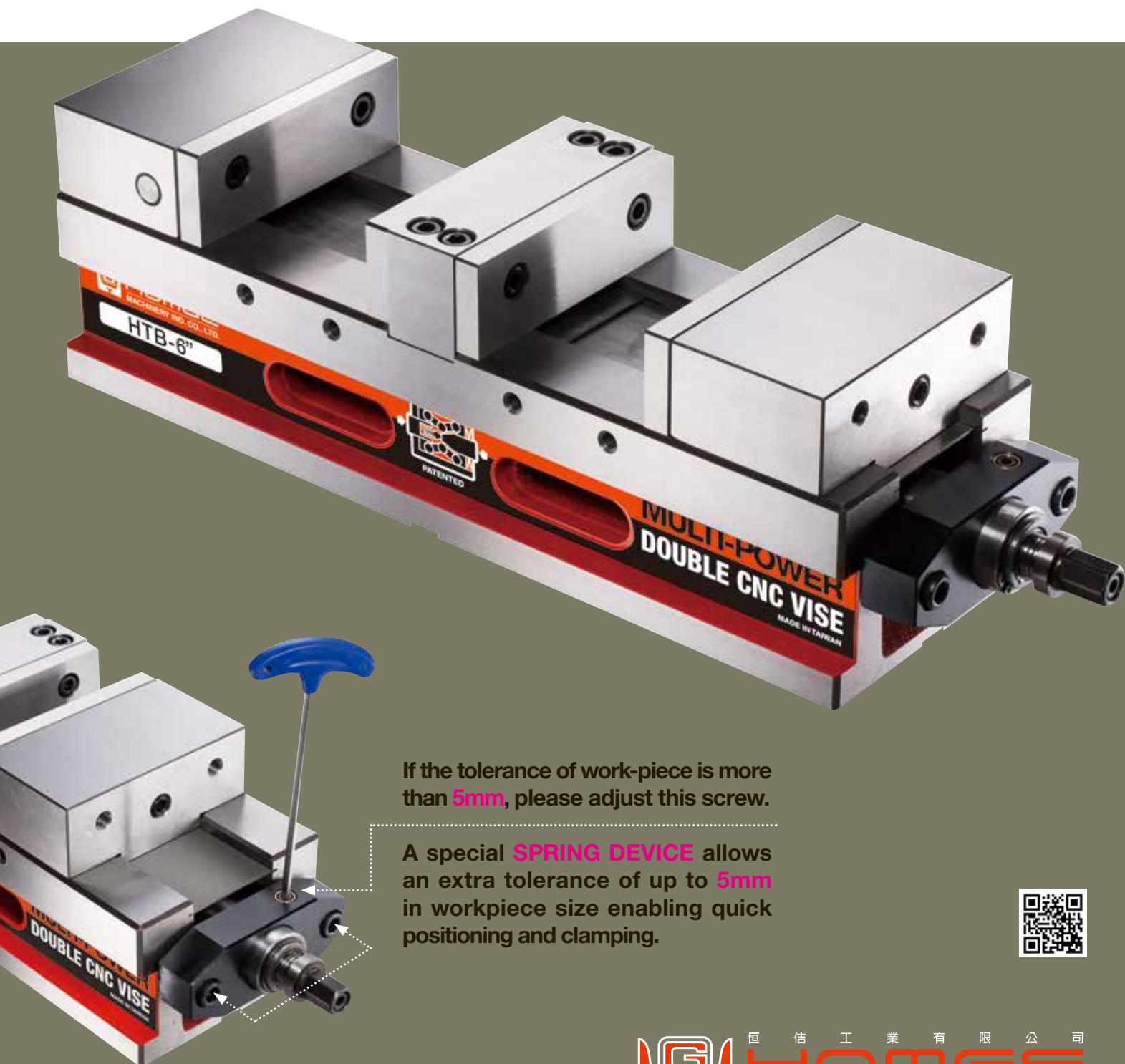

DOUBLE CNC MULTI-POWER VISE

Significantly upgrade CNC Machining Centers



If the tolerance of work-piece is more than **5mm**, please adjust this screw.

A special **SPRING DEVICE** allows an extra tolerance of up to **5mm** in workpiece size enabling quick positioning and clamping.



Double CNC Multi-Power Vise

Model: HTB-5", 6", 8"

1. A special **SPRING DEVICE** allows an extra tolerance of up to **5mm** in workpiece sizes, which enables automatically quick positioning and clamping.
2. The vise can hold 2 workpieces of different sizes with max. difference of **25mm**.
3. The **Special ANGLE-LOCK SYSTEM** with compact design and high-grade iron of over FCD 60 grade for high rigidity automatically pulls the workpiece down to its accurate position.
4. **Fixed Height**, so several vises can be used together.
5. Double Leadscrew Covers protect Leadscrew from swarf.

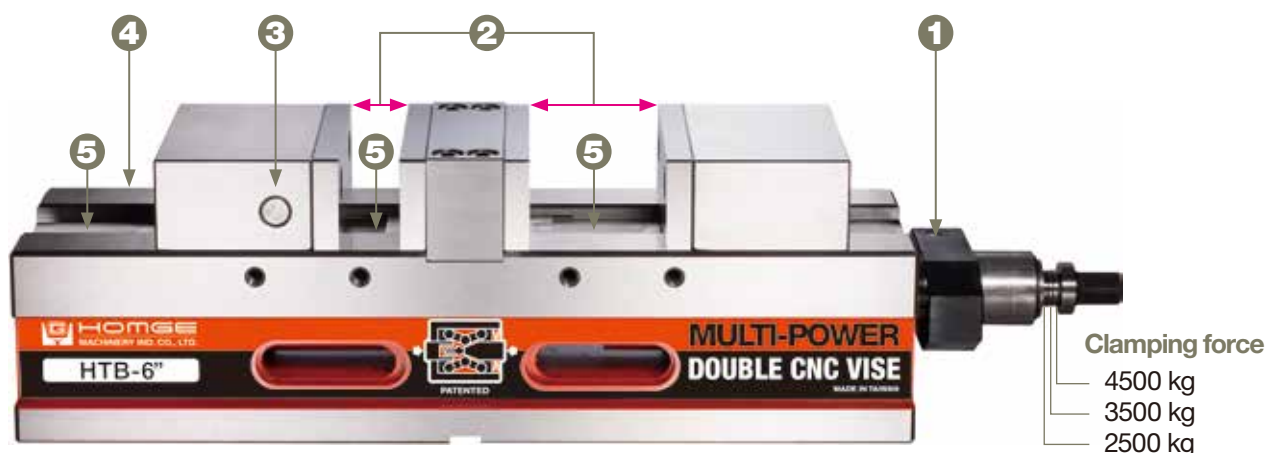

DIMENSIONS



STANDARD ACCESSORIES:

- 2 pcs of Alignment Wedge
- 4 pcs of Clamp
- 1 pc of Wrench
- 1 pc of T Type Wrench

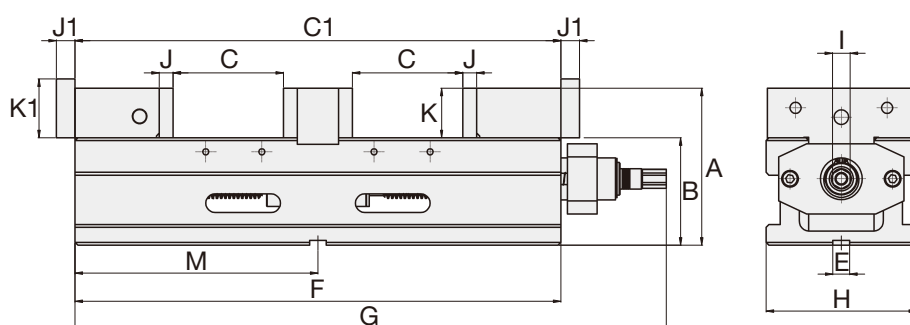

SPECIFICATIONS (Material: FCD60 Ductile Iron. Hardness:HRC 50°)

Unit: mm

Model	A	B	C	C1	E	F	G	H	I	J	J1	K	K1	M	Weight (kg)
HTB-5"	168	115±0.01	94	472	18	472	584	134	19	15	20	53	63	236	53
HTB-6"	168	115±0.01	120	520	18	520	632	161	19	15	20	53	63	260	62
HTB-8"	187	120±0.01	150	620	18	620	732	200	19	18	24	66	75	310	112



Factory: No.287, Sec. 1, Shenlin Rd., Daya Dist., Taichung City 428, Taiwan
Tel: 886-4-2567 2057 . 2566 6158 | **Fax:** 886-4-2567 2016 . 2568 6099
E-mail: homge@ms22.hinet.net | **http:**://www.homge.com.tw

