



### 油壓動力單元

特殊設計的油壓迴路，提供工作台行程動作的平穩順暢，可維持行程兩端不抖動，確保研磨品質。



### HYDRAULIC POWER UNIT

The specially designed hydraulic circuit allows the worktable to move stably and smoothly. This can eliminate chatter at both ends of the travel, while ensuring high quality grinding.

### 標準附件 STANDARD ACCESSORIES

- 法蘭
- 法蘭拆具
- 平衡棒
- 水平調整螺絲
- 電氣箱冷氣式熱交換器
- 平衡台
- 腳墊
- 工具箱及工具
- 工具燈
- 鑽石筆及座
- 砂輪
- 自動潤滑系統
- 操作手冊
- Wheel flange
- Flange extractor
- Wheel balancing arbor
- Leveling screws
- Heat exchanger for electric cabinet
- Wheel balancing stand
- Leveling pads
- Toolbox and tools
- Working lamp
- Diamond dresser and stand
- Grinding wheel
- Automatic lubrication system
- Operator's manual

### 特殊附件 OPTIONAL ACCESSORIES

- 電磁盤
- 電永磁盤
- 磁性過濾水機
- 紙帶過濾水機
- 磁性加紙帶過濾水機
- 油壓循環冷卻機
- 光學尺
- 變頻器
- 全罩式防濺護罩
- 油霧回收機
- 輪頂修整器
- 鑽石滾輪修整器
- Electromagnetic chuck
- Permanent magnetic chuck
- Coolant system with magnetic separator
- Coolant system with paper filter
- Coolant system with paper filter and magnetic separator
- Hydraulic circulated cooler
- Linear scale
- Frequency inverter
- Fully enclosed splash guard
- Oil mist collector
- Parallel wheel dresser
- Diamond roller dresser

機型	MODEL	JL-63CNC-BL	JL-1000HR
<b>旋轉工作台</b>	<b>ROTARY TABLE</b>		
工作台直徑	Table diameter	Ø600 mm	Ø1000 mm
最大旋徑	Max. swing	Ø650	Ø1000 mm
最大行程研磨半徑	Max. grinding radius	350 mm	510 mm
移動轉速	Table rotating speed	20~150 rpm	10~100 rpm
主軸中心至工作台面最大距離	Max. distance from table surface to spindle center	500 mm	600 mm
磁盤尺寸(直徑 x 高度)	Size of electromagnetic chuck (Dia. x H)	Ø600 x 90 mm	Ø1000 x 120 mm
工作台最大載重	Max. table load	600 kg	1200 kg
伺服馬達	Servomotor	3.1 kw	7.5 kw
<b>砂輪主軸</b>	<b>WHEEL SPINDLE</b>		
主軸馬達	Spindle motor	7.5H x 4P (選配 opt. 10H x 4P)	15H x 4P (選配 opt. 15H x 6P, 20H x 6P, 25H x 6P / 伺服 Servo 20 kw)
轉速	Wheel speed	線速度 Linear speed <33m/s	線速度 Linear speed <33m/s
砂輪尺寸(外徑 x 寬度 x 內徑)	Wheel sizes (O.D. x W x I.D.)	355 x 50 x 127 mm	405 x 50 x 127 mm
<b>左右進給</b>	<b>LONGITUDINAL FEED</b>		
行程	Stroke	650 mm	-
滾珠螺桿(直徑 x 螺距)	Ballscrew (dia. x pitch)	Ø40 x 5 mm	-
伺服馬達	Servomotor	2.4 kw	-
移動速度	Infeed rate	1500 m/min (60Hz)	-
最小設定單位	Least input increment	0.001 mm	-
軌道	Guideway	雙V軌道 Double "V" ways	-
<b>上下進給</b>	<b>VERTICAL FEED</b>		
行程	Stroke	350 mm	470 mm
滾珠螺桿(直徑 x 螺距)	Ballscrew (dia. x pitch)	Ø40 x 5 mm	Ø50 x 5 mm
伺服馬達	Servomotor	2.4 kw	2 kw
減速比	Speed reduction ratio	1:5 / 減速機 Speed reducer	1:20 / 蝸輪箱減速 Worm gear reducer
移動速度	Infeed rate	750 m/min	750 m/min
最小設定單位	Least input increment	0.001 mm	0.001 mm
軌道	Guideway	線性滑軌 Linear guideways	線性滑軌 Linear guideways
<b>前後進給</b>	<b>CROSS FEED</b>		
行程	Stroke	-	710 mm
滾珠螺桿(直徑 x 螺距)	Ballscrew (Dia. x Pitch)	-	Ø50 x 5 mm
伺服馬達	Servomotor	-	2 kw
移動速度	Infeed rate	-	1500 m / min (60Hz) / 1250 m / min (50Hz) / 2500 m / min (伺服 Servo)
最小設定單位	Least input increment	-	0.001 mm
軌道	Guideway	-	雙V軌道 Double "V" ways
<b>馬力</b>	<b>MOTOR</b>		
總額定馬力(約)	Total rated horsepower (approx.)	-	50 HP
<b>電壓</b>	<b>VOLTAGE</b>		
總額定電壓(約)	Total rated voltage (approx.)	220V / 60Hz	-
<b>電流</b>	<b>CURRENT</b>		
總額定電流(約)	Total rated current (approx.)	63A	80A
<b>重量</b>	<b>WEIGHT</b>		
機器重量	Machine weight	6000 kg	10000 kg
裝箱	Packing gross weight	6200 kg	12000 kg
<b>空間</b>	<b>SPACE OCCUPIED</b>		
機器尺寸(長 x 寬 x 高)	Machine dimensions (L x W x H)	3350 x 1680 x 2400 mm	3350 x 4300 x 2400 mm
佔地面積(長 x 寬)	Floor space (L x W)	3350 x 1680 mm	3350 x 4300 mm
裝箱尺寸(長 x 寬 x 高)	Packing dimensions (L x W x H)	3400 x 1800 x 2550 mm	2200 x 4300 x 2550 mm

\* 本公司對產品樣式及規格不斷研發創新，如規格變動，恕不另行通知。 \* Machine specifications and design characteristics are subject to change without prior notice.



準力機械股份有限公司 JOEN LIH MACHINERY CO., LTD.

42756 台中市潭子區大豐路1段240之1號 No. 240-1, Sec. 1, Tafeng Rd., Tantzai Dist., Taichung City 427, Taiwan

TEL: +886-4-2534-9475

FAX: +886-4-2533-9001

E-mail: grinder@joenlih.com.tw

http://www.joenlih.com.tw



JL-2023-03-1000EC



## CNC ROTARY TABLE SURFACE GRINDER

### CNC轉盤式平面磨床

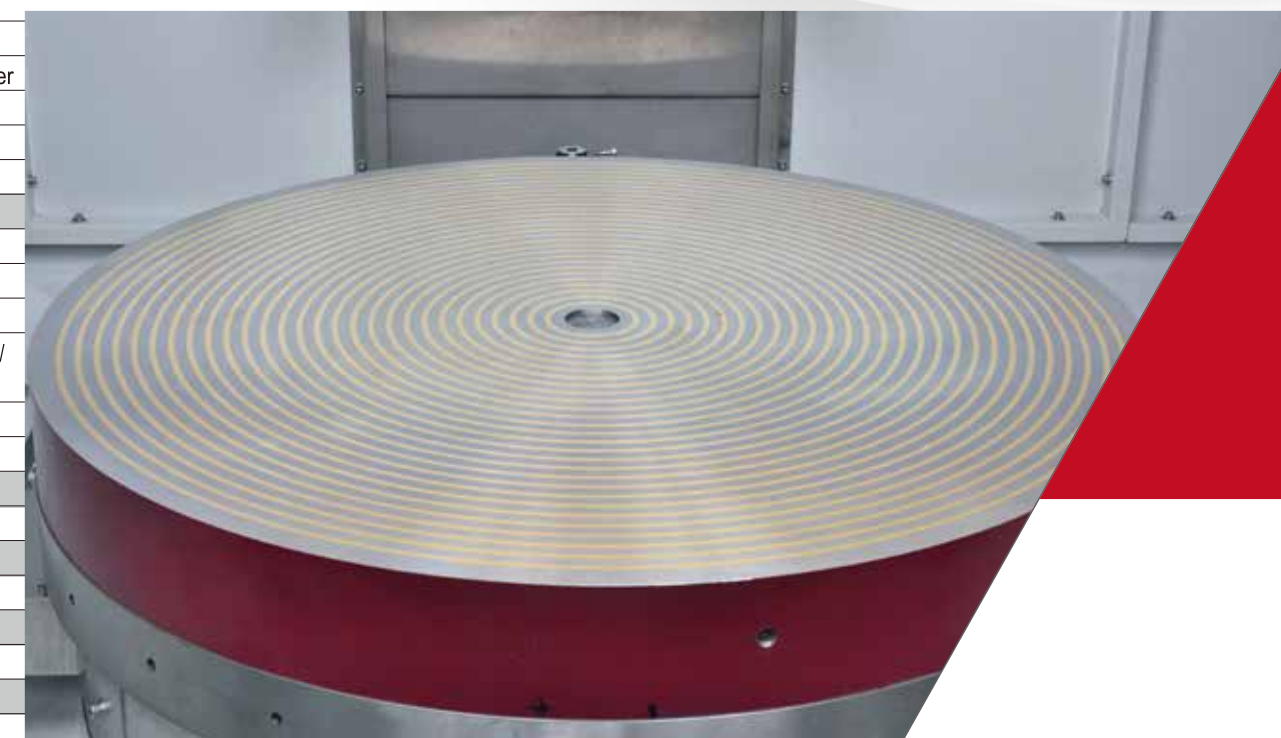

JL-63CNC-BL  
&  
JL-1000HR



# JL-63CNC-BL

## 機器特性 MACHINE FEATURES

- 旋轉工作台尺寸: Ø600 mm。
  - 兩軸CNC: 左右、上下。
  - 主軸砂輪為縱向研磨。
  - 全密閉式護罩。
  - 只需跑完一半的行程，即能完成全部行程之加工。
- Diameter of rotary table: Ø600 mm
  - Two axes CNC movement: longitudinal and vertical
  - Longwise Spindle
  - Vertical feed on Y-axis is mounted with linear guideways
  - Fully enclosed splash guard.
  - The grinding wheel can finish a full program of grinding with just half distance run.

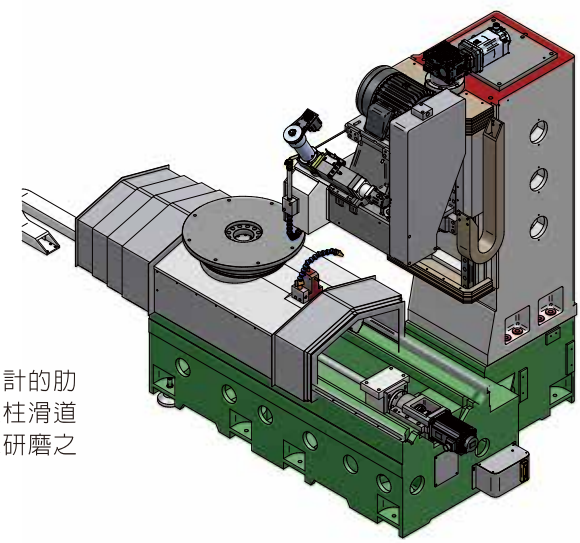

### ◀ 縱向主軸

縱向主軸設計，朝工作台左右橫移、上下進給。左右與升降軌道為線性滑軌。驅動方式皆採用AC伺服馬達驅動，並經由精密滾珠螺桿傳動。定位精準，速度快。附MPG電子手輪，微調精度可達0.001mm。

### LONGWISE SPINDLE

The spindle is for longwise grinding and moves in longitudinal and vertical direction. Both axes are linear guideways and driven by an AC servomotor and transmitted through a precision ballscrew for accurate positioning and fast feed. Equipped with an electronic handwheel (MPG), it allows for micrometric adjustment accuracy of 0.001mm.

### ◀ 兩種修砂方式：

工作台旁和砂輪頂部，各配有一個修砂裝置，兼顧精度與速度的加工方式。

Tabletop diamond tool stand and overhead wheel dresser are both equipped on this machine to fulfill high accuracy and efficiency of processing.

### ◀ 蜂巢式結構

立柱採用高級鑄鐵製式，配合特殊設計的肋骨強化立柱的剛性與研磨穩定性。立柱滑道配置精密線軌，穩定性優異，可確保研磨之高精度。

### HONEYCOMB-SHAPED STRUCTURE OF COLUMN

The column is manufactured from high quality cast iron and reinforced by specially designed honeycomb-shaped ribs. The slideways on the column are mounted with high precision linear guideways, providing outstanding stability and high accuracy of grinding.

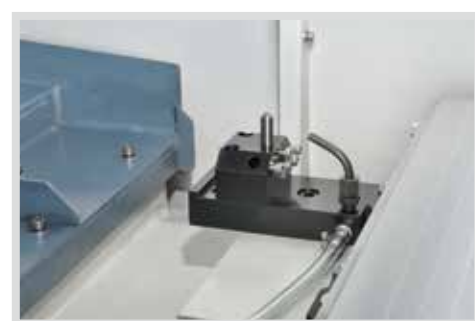
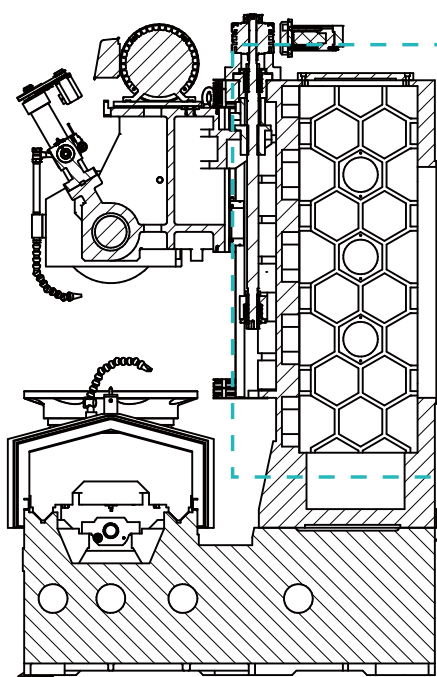

# JL-1000HR

## 機器特性 MACHINE FEATURES

- 旋轉工作台直徑Ø1000 mm。
  - 兩軸CNC: 前後、上下。
  - 工作台為液靜壓驅動。
  - 全密閉式護罩。
  - Y軸上下進給配置線性滑軌。
  - Z軸前後進給為“V”滑道。
- Diameter of rotary table: Ø1000 mm
  - Two axes CNC movement: cross and vertical
  - Rotary table is driven by hydrostatic pressure.
  - Fully enclosed splash guard.
  - Vertical feed on Y-axis is mounted with linear guideways
  - Cross feed on Z-axis is designed with double “V” ways.

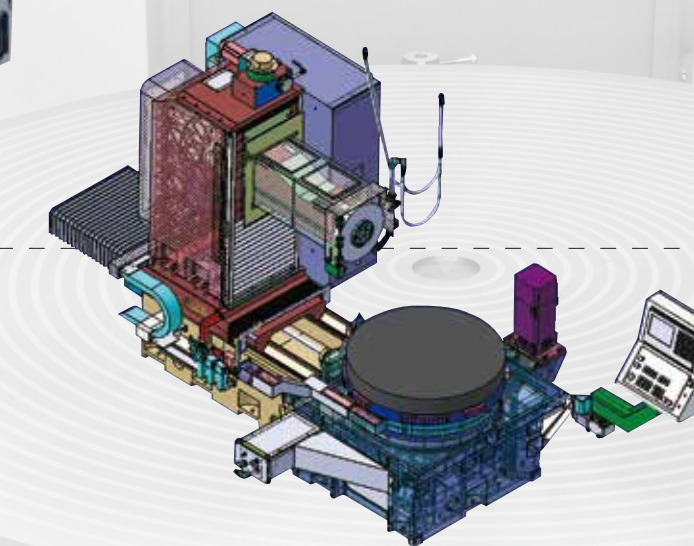

## 傑出的設計 OUTSTANDING DESIGN

### 升降進給

Y軸升降軌道為線性滑軌，採用伺服馬達驅動，配合精密滾珠螺桿傳動。定位精準、速度快。升降重複訂位精度可達0.002 mm。

### VERTICAL MOVEMENT

The vertical movement is driven by a servomotor and transmitted through a ballscrew for accurate positioning and fast feed. Mounted with precision linear guideway, the repeatability of positioning accuracy on vertical axis can reach 0.002 mm.

### 油溫控制系統

獨立油溫及精準油壓控制系統，長時間運轉也不會有溫昇、摩擦、熱變形。

### HYDRAULIC TEMPERATURE CONTROL SYSTEM

Independent hydraulic system allows for precise control of hydraulic temperature. No temperature rising, friction nor thermal deformation will be generated under long-time working.

### 前後進給

Z軸前後進給軌道採用雙“V”滑道設計，滑道面貼附Turcite-B耐磨片，再經錐花處理。工作台移動順暢。前後進給採用伺服馬達驅動，配合精密滾珠螺桿驅動，前後重複訂位精度可達0.001 mm。

### CROSS FEED MOVEMENT

The Z-axis cross feed guideway is double V slideways, coated with Turcite-B wear-resistant media and then precision scraped to ensure maximum smoothness for table movement. Driven a servomotor and transmitted through a ballscrew, the repetitive positioning accuracy on cross feed axis is 0.001 mm.



### 液靜壓旋轉工作台

液靜壓旋轉工作台液靜壓旋轉工作台，採用液靜壓軸承支撐旋轉工作台。無金屬磨耗問題，工作台旋轉輕巧順暢、高精度、抗震效果優異，適合高精度研磨之需求。

### HYDROSTATIC ROTARY TABLE

The hydrostatic rotary table employs hydrostatic bearings to support the rotary table. As there is no friction between metal parts, the table can rotate effortlessly and smoothly with outstanding accuracy and damping effect.

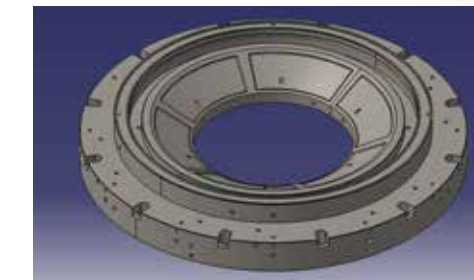

### 特殊設計的油室

精準控制油壓，只要薄薄一層液壓油，就能讓旋轉工作台浮起，工作台運轉時也不會與軸承產生接觸與摩擦。

### RECESS PRESSURE

Accurate control of hydraulic pressure. A thin film of oil can lift the rotary table. The table won't contact the bearings, thus no friction will be generated.



CNC ROTARY TABLE  
SURFACE GRINDER  
CNC轉盤式平面磨床



**JL-63CNC-BL  
&  
JL-1000HR**



準力機械股份有限公司 JOEN LIH MACHINERY CO., LTD.