

PATENTED
1 2 6 2 1 9
M307481

MULTI-POWER FIXED ANGLE PRECISION VISE (EXTENDED TYPE)

Model: HMAV-160, 200

The **SUPER-OPENING** design allows the jaws to open 310mm for HMAV-160 and 395mm for HMAV-200. With the Jaws mounted externally, the maximum work holding capacity is 450mm for HMAV-160 and 550mm for HMAV-200.

ANGLE-LOCK MECHANISM provides downward pressure on Jaw during clamping ensuring Jaws remain parallel and work is held accurately.

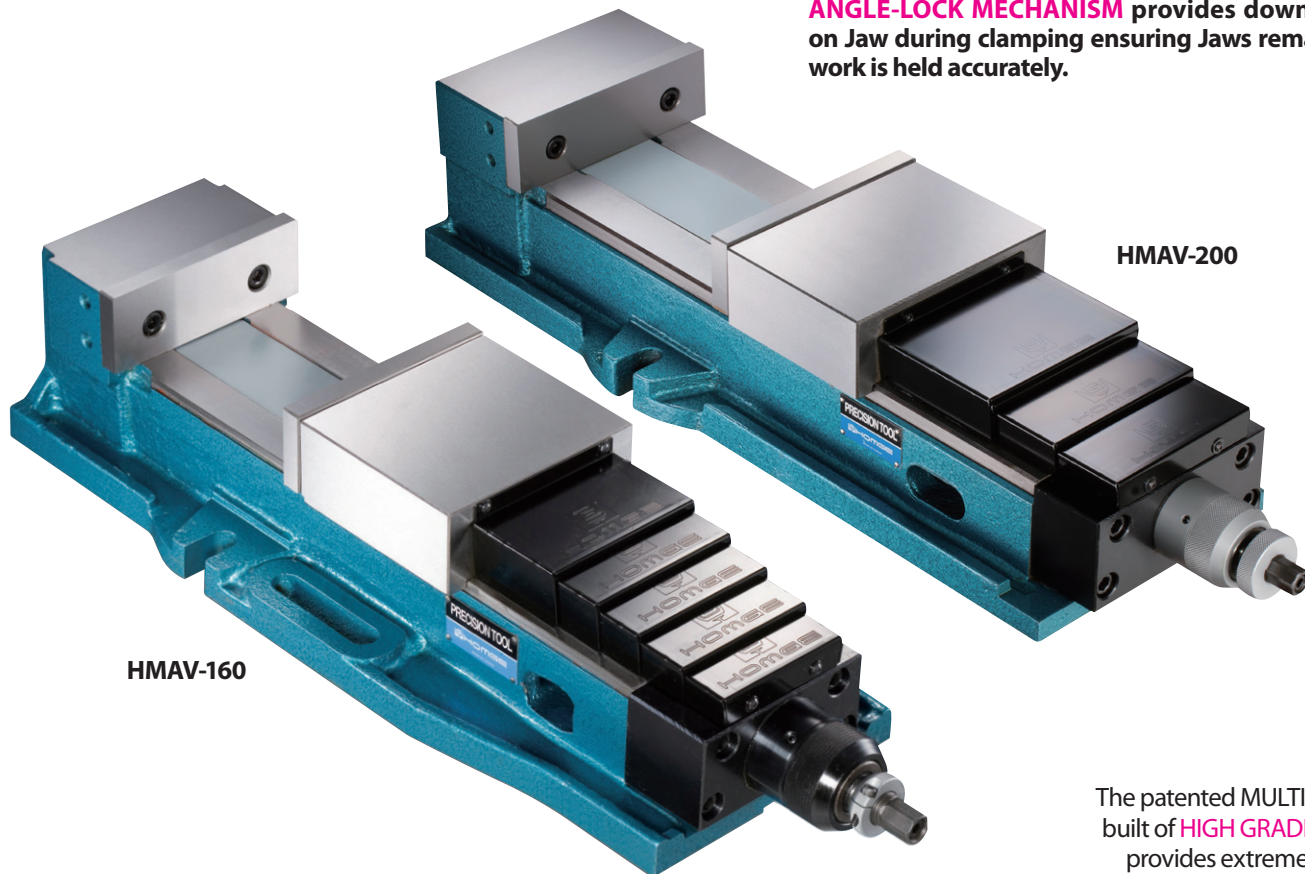

HMAV-160

HMAV-200



The patented MULTI-POWER SYSTEM built of **HIGH GRADE BEARING STEEL** provides extremely high clamping pressure. The pressure is more consistent and eliminates all leakage and maintenance problems associated with Hydraulic Vises.

STANDARD FIXED ANGLE PRECISION VISE (EXTENDED TYPE)

Model: HEAV-160, 200

This vise has the same features as model HMAV above but has standard clamping Leadscrew instead of the MULTI-POWER SYSTEM. The **SUPER-OPENING** design allows the jaws to open 340mm for HEAV-160 and 425mm for HEAV-200. With the Jaws mounted externally, the maximum work holding capacity is 480mm for HEAV-160 and 580mm for HEAV-200.

HEAV-160

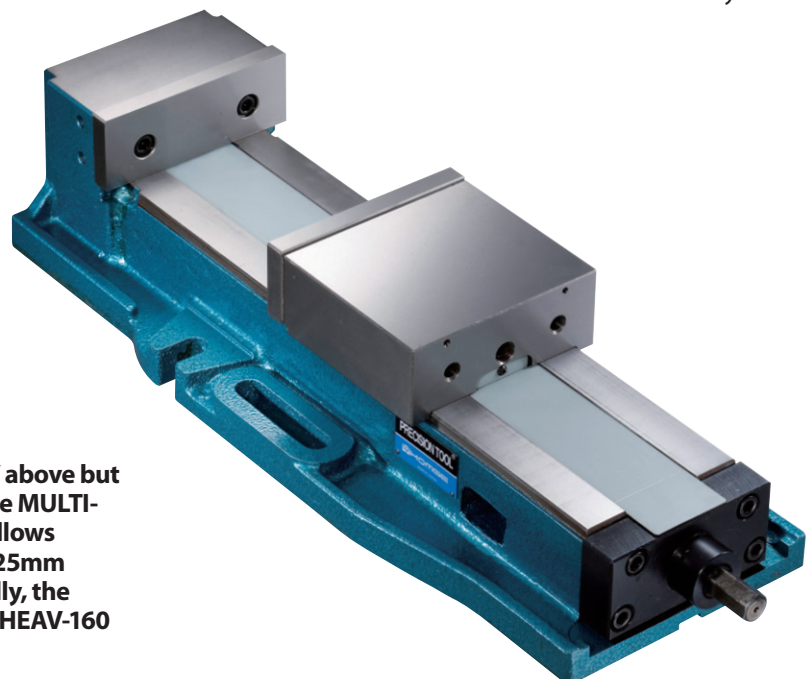

DIMENSIONS FOR 2 JAW PLATE POSITIONS

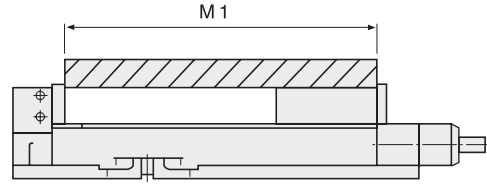
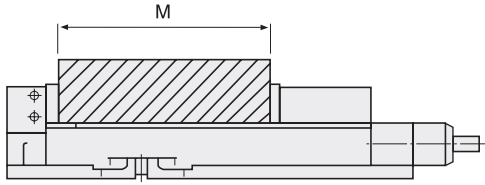

DIMENSIONS

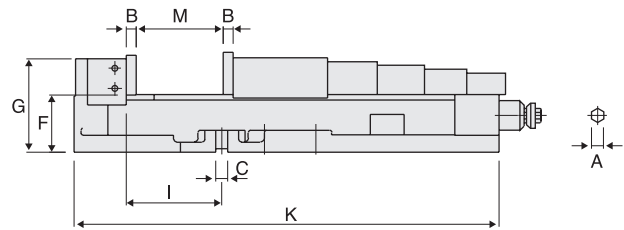
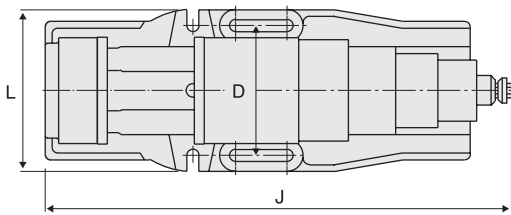

SPECIFICATIONS (Material: FCD 60 Ductile Iron. Hardness: HRC 50°)

Unit: mm

Model	A	B	C	D	F	G	I
HMAV-160	19	15	18	192	85 ± 0.01	140	141 ± 0.02
HMAV-200	19	18	18	240	100 ± 0.01	160	190 ± 0.02
Model	J	K	L	M	M1	Weight (kg)	
HMAV-160	740	628	240	310	140-450	50	
HMAV-200	830	720	280	395	155-550	95	

DIMENSIONS

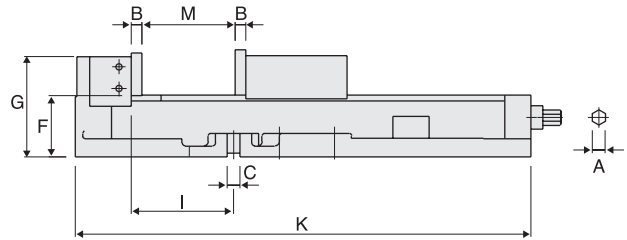
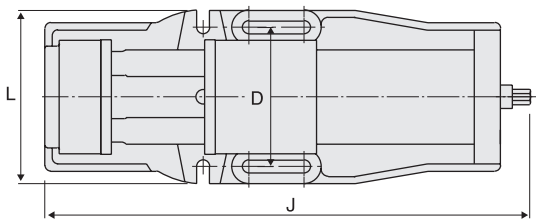

SPECIFICATIONS (Material: FCD 60 Ductile Iron. Hardness: HRC 50°)

Unit: mm

Model	A	B	C	D	F	G	I
HEAV-160	19	15	18	192	85 ± 0.01	140	141 ± 0.01
HEAV-200	19	18	18	240	100 ± 0.01	160	190 ± 0.01
Model	J	K	L	M	M1	Weight (kg)	
HEAV-160	683	628	240	340	140-480	50	
HEAV-200	775	720	280	425	155-580	95	