

CNC IK-451011





SPECIFICATION

MODEL	Unit	IK-450811	IK-451011
<u>Working Range</u>			
Z-axis Traverse	mm	800	1000
Spindle Nose Length	mm	90 / 190	
Z-axis Ball Screw Specification	mm	Φ50 / P10	
Servo Motor Specification	Kw/Hp	7 / 9.4	
<u>Spindle</u>			
Tapered Bore Diameter		ISO 50	
Spindle Motor	Kw/Hp	18.5 / 25 (22 / 30)	
Spindle Speed (2-Step Gear Type)	rpm	4500 (Standard) 6000 (Optional)	
Weight (Approximate)	kg	2,100	2,300
<u>STANDARD ACCESSORIES</u>			
CNC Gear Plano Milling Head (4500RPM/BT50)		●	
Ladder Slide		●	
Z-axis Draw bar		●	
Z-axis Counterweight Cylinder		●	
Z-axis Wiper		●	
Type of Guide		Y、Z axis Square Guide-way	
Lock Knife Block (Include Lock/Unlock Sensor)		●	
Shift Cylinder (Include High/Low Sensor)		●	
Spindle Positioning Sensor		●	
Splash Guard		●	
Oil Pressure Pipe		●	
<u>OPTIONAL ACCESSORIES (APOLEGAMY)</u>			
CNC Gear Plano Milling Head (6000RPM/BT50)		○	
IK-N90 (Milling Head Accessory)		○	
IK-N90+N95(Milling Head Accessory)		○	
Place of Origin		Taiwan	
Warranty		1 year (non artificial mistake)	
Note: This product does not contain a servo motor (Z-axis motor and spindle motor). Recommended specifications §Spindle servo motor (18.5Kw / 25Hp or 22Kw / 30Hp) §Z-axis servo motor (7Kw / 9.4Hp) ※Please provide a servo motor sizes (Z-axis motor and spindle motor).			

※We reserve the right to modify the design and specifications without notice in advance.



IK-N90+N95 Application for Patent

IK-N95

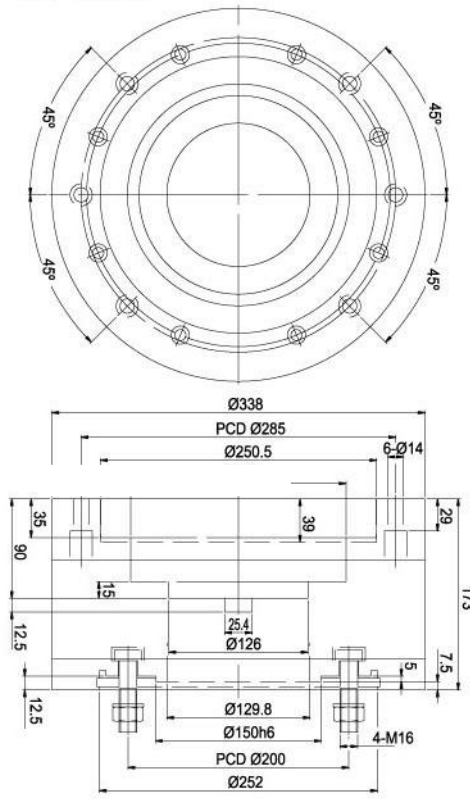

Note: With short spindle nose 90mm

IK-N90

Angular Head

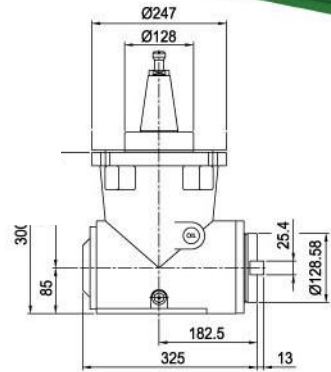

Model no.	IK-N90
Product name	90度頭2000RPM 90 degree head 2,000rpm
Spindle	NT 50
Ratio	1:1
Oil type	Shell Spirax G Oil ISO68