

Barrel Cam Drive 4 Axis

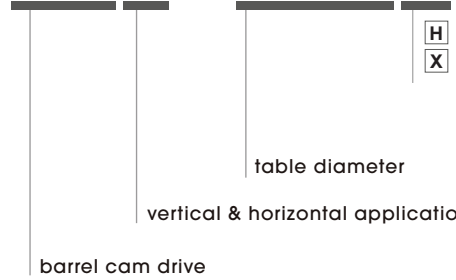

RGX-170X RGX-210X
RGX-255H RGX-320H

RGX - 210X



- [H] Hydraulic brake
- [X] Hydraulic clamp by air booster built in

- Rolling contact reserves high rigidity, high speed and long endurance.
- Least drive energy wear-out and more than 90% transmission rate.
- Backlash-free from rolling motion achieves high accuracy.
- RGX170/210X built-in air booster system assures more superior clamping force (additional hydraulic tank not required).**



◀ RGX-250XII

SPECIFICATIONS

MODEL SPECIFICATIONS	單位	RGX-170XII	RGX-210XII RGX-250XII	RGX-255H	RGX-320HII
Workable diameter	mm	Ø170	Ø210 / Ø255	Ø255	Ø320
Center bore diameter	mm	Ø40H7	Ø40H7	Ø140H7	Ø180H7
Through hole diameter	mm	Ø40	Ø40	Ø90	Ø140
Height of center	mm	160	160	190	210
Clamping method / pressure	MPa	0.6-0.7 Pne (air-oil converter)	0.6-0.7 Pne (air-oil converter)	5 Hyd	5 Hyd
Clamping torque	N.m	420	420 / 340	900	1600
Transmission ratio		1/30	1/30	1/60	1/60
Max. rotation speed	min ⁻¹	83.3	83.3	50	40
Indexing accuracy	sec.	20	20	20	20
Repeatability	sec.	6	6	6	6
Allowable loading inertia	Kg.m ²	0.72	0.72 / 0.54	2.43	5.12
Allowable cutting torque	N.m	190	190	780	1055
Allowable loading capacity	Vertical	Kg	100	100 / 75	150
	Horizontal	Kg	200	200 / 150	300
	Tailstock applied	Kg	200	200 / 150	300
Net Weight (servo motor excluded)	Kg	72	75 / 82	126	200

DIMENSIONAL DRAWINGS

Unit : mm

RGX-170XII

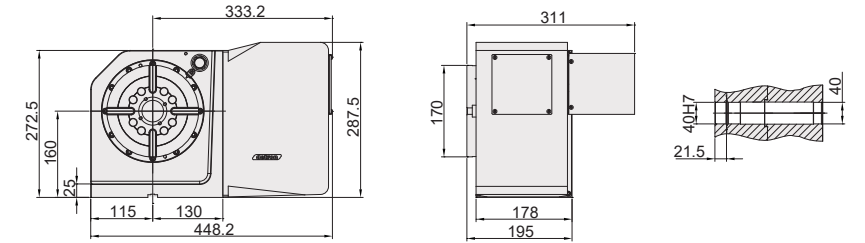

RGX-210XII / RGX-250XII

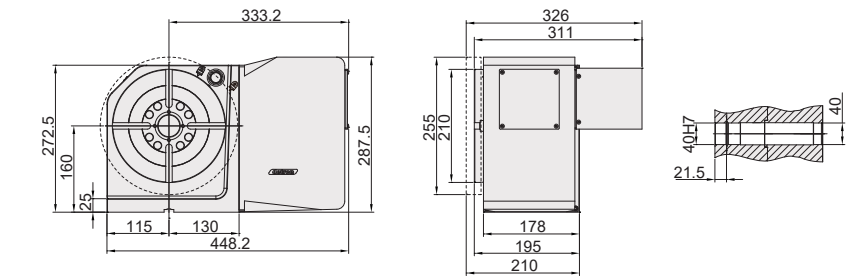

RGX-255H

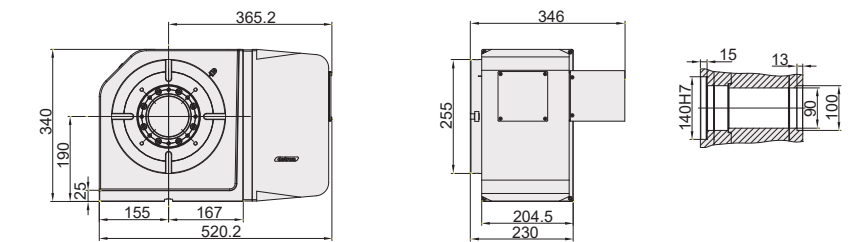

RGX-320HII

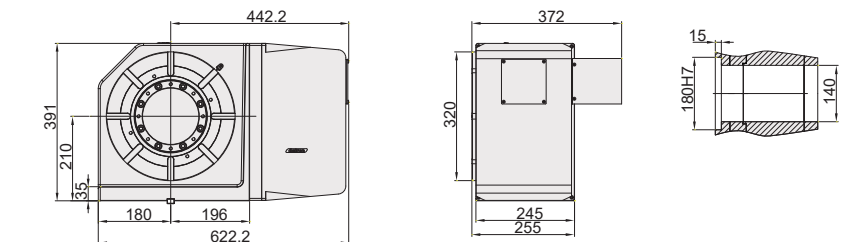

Note: 1. The length of servo guard may vary with servo motor type. (metal sheet dimensions shown above are based on Fanuc motor)
Brake system must remain CLAMP status when power failure happens, otherwise, it may cause the dropping of the rotary table under different situations of the facilities and work pieces.