



PERMANENT MAGNETIC LIFTER

Suitable for moving workpiece and molds that made of magnetic material steel, iron and cast iron



恒 信 工 業 有 限 公 司
HOMGE
MACHINERY IND. CO., LTD.

永磁式磁力吊盤

Permanent Magnetic Lifter

ECMC-M 100, M 300, M+600, M 1000, M 2000

- Made of permanent Neodymium magnet, no electricity, no power outage risk.
 - The safety factor is 3.5 times. Permanent Magnetic Lifter provides strong and stable magnetic force with easy operation and increase productivity.
 - The special V-type design at the bottom of Permanent Magnetic Lifter can lift the steel plate and round steel...etc.
 - Suitable for moving workpiece and molds that made of magnetic material steel, iron and cast iron.
Applicable areas: Steel industries, foundries, fabrication factories, shipyards and transport industries.
- 使用永久性強磁 - 釹鐵硼磁鐵製造，永不退磁、無需電力，無斷電風險。
 - 安全係數 3.5 倍，使用更安全；磁力強大且穩定，操作方便更省力，能有效提升工作效率。
 - 獨特的底部 V 型槽設計，能吊起鋼板與圓柱鋼鐵材。
 - 可用於搬運各類鋼材、鐵材及鑄鐵等具磁性工件物與模具；適用場所：製造加工廠、鑄造廠、倉庫、船舶造船廠、運輸業等。

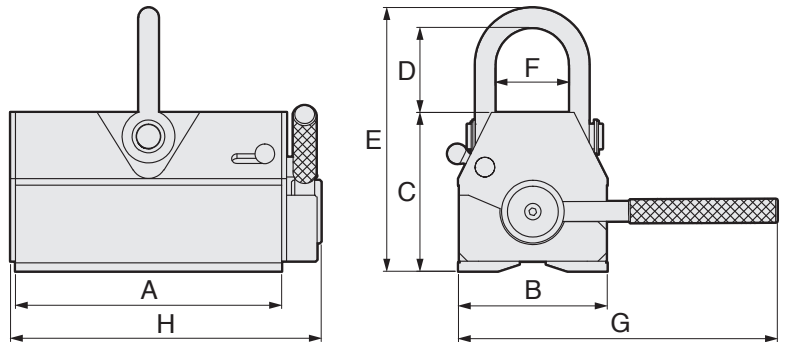

SPECIFICATIONS

Unit: mm / inch

Model	A		B		C		D		E		F		G		H		Safety factor 安全係數	Weight 重量	
	mm	inch	mm	inch	mm	inch	mm	inch	mm	inch	mm	inch	mm	inch	kg	lbs			
ECMC-M 100	90	3.5	60	2.4	75	3	46	1.8	130	5.1	32	1.3	136	5.4	116	4.6	× 3.5	3	6.6
ECMC-M 300	161	6.3	90	3.5	96	3.8	51	2	160	6.3	45	1.8	193	7.6	189	7.4		9	19.8
ECMC-M+600	234	9.2	120	4.7	123	4.8	74	2.9	213	8.4	64	2.5	261	10.3	263	10.4		23	50.6
ECMC-M 1000	269	10.6	170	6.7	170	6.7	94	3.7	285	11.2	100	3.9	376	14.8	301	11.9		54	118.8
ECMC-M 2000	390	15.4	216	8.5	215	8.5	105	4.1	348	13.7	121	4.8	512	20.2	432	17		121	266.2

Model	Steel Plate Max. load 鋼板 - 最大負重		Min. thickness 最小厚度		Round Steel Max. load 圓形鋼材 - 最大負重		Ø Max. diameter 最大直徑		Max. length 最大長度	
	kg	lbs	mm	inch	kg	lbs	mm	inch	mm	inch
ECMC-M 100	100	220	15	0.6	50	110	150	5.9	500	19.7
ECMC-M 300	300	660	25	1	150	330	250	9.8	800	31.5
ECMC-M+600	600	1320	30	1.2	300	660	350	13.8	1200	47.2
ECMC-M 1000	1000	2200	40	1.6	500	1100	450	17.7	1500	59
ECMC-M 2000	2000	4400	55	2.2	1000	2200	550	21.7	1800	70.9



HOMGE MACHINERY IND. CO., LTD.

Factory: No.287, Sec. 1, Shenlin Rd., Daya Dist., Taichung City 428, Taiwan

Tel: 886-4-2567 2057 . 2566 6158 | Fax: 886-4-2567 2016 . 2568 6099

E-mail: homge@ms22.hinet.net | http://www.homge.com.tw